

CL.1 Wall-mounted basin spout without pop-up waste - Brushed Champagne (22kt Gold)

CL.1

<div>13 800 705 Product version from 3/9/2015</div> <div>  </div>	<ul style="list-style-type: none"> • 200mm projection • fixed spout • rectangular spray pattern with 40 individual jets • hole diameter 37 mm • lead-free • 1/2" connection • plug-link mounting • max. flow 4.5 l/min • This product can help a building meet the requirements of Green Building Rating Systems, e.g. LEED®, BREEAM®, DGNB • WRAS 			<div>Brushed Champagne (22kt Gold)</div> <div>13 800 705-46</div>
				<div>Chrome</div> <div>13 800 705-00</div>
				<div>Brushed Platinum</div> <div>13 800 705-06</div>
				<div>Dark Chrome</div> <div>13 800 705-19</div>
				<div>Champagne (22kt Gold)</div> <div>13 800 705-47</div>
				<div>Brushed Dark Platinum</div> <div>13 800 705-99</div>

CL.1 Wall-mounted basin spout without pop-up waste - Brushed Champagne (22kt Gold)

CL.1

13 800 705 Product version from 3/9/2015
mm [inches]

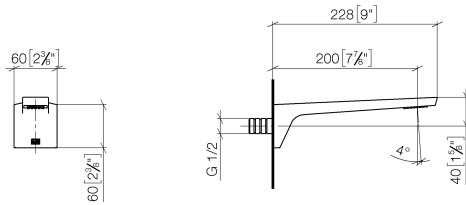

Flow rate chart

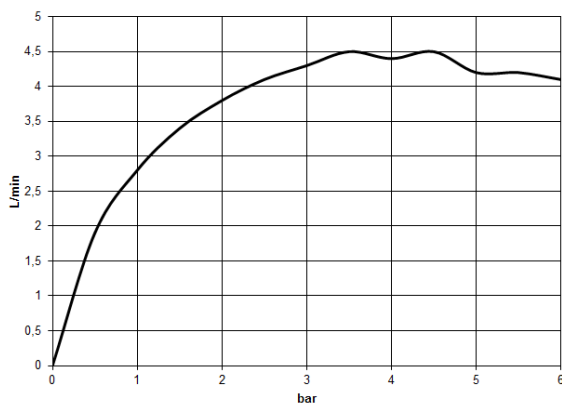

Codes & Standards

ASME A112.18.1

cUPC

EPA WaterSense

NSF372

NSF61

WaterSense





CL.1 Wall-mounted basin spout without pop-up waste - Brushed Champagne
(22kt Gold)

CL.1

13 800 705 Product version from 3/9/2015

Certificates and sustainability

IAPMO_N-4	IAPMO_4976	IAPMO_8834	IAPMO_6
-----------	------------	------------	---------

CL.1 Wall-mounted basin spout without pop-up waste - Brushed Champagne (22kt Gold)

CL.1

13 800 705 Product version from 3/9/2015

Parts for other
finishes can be found
here: [Chrome](#)

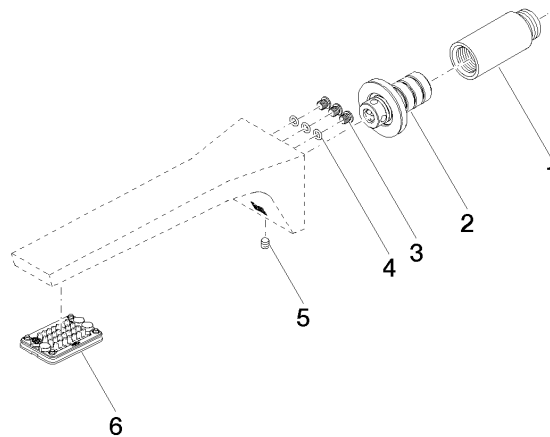

Spare parts list

No.	Item Number	Name	Quantity used	Delivery time
2	90 24 03 108 01 90	nipple set	1.00	2
4	09 14 10 001 90	seal	3.00	2
1	09 24 03 081 10 90	extension	1.00	2
6	90 11 02 297 00 90	aerator	1.00	2
5	90 31 11 004 00 90	pin	1.00	2
3	09 30 30 113 20 90	screw	3.00	2