







MEM Bath spout for wall mounting - Brushed Durabrand (23kt Gold)

MEM

13 801 782



- 220mm projection
- rectangular, air-enriched flow
- rosette 60 x 60 mm
- hole diameter 37 mm
- 1/2" connection
- max. flow 38.5 l/min at 3 bar flow pressure
- WRAS 2203039

| | | |
|--|-------------------------------|---------------|
|  | Brushed Durabrand (23kt Gold) | 13 801 782-28 |
|  | Chrome | 13 801 782-00 |
|  | Brushed Platinum | 13 801 782-06 |
|  | Platinum | 13 801 782-08 |
|  | Dark Chrome | 13 801 782-19 |
|  | Brushed Champagne (22kt Gold) | 13 801 782-46 |
|  | Champagne (22kt Gold) | 13 801 782-47 |
|  | Brushed Dark Platinum | 13 801 782-99 |

Recommended miscellaneous



Concealed wall elbow -

35 085 970 90

- max. recess depth 163 mm
- min. recess depth 90 mm

13 801 782

mm [inches]

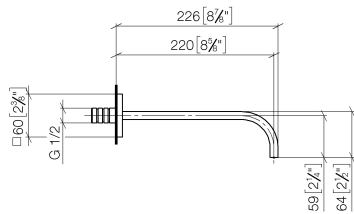

Flow rate chart

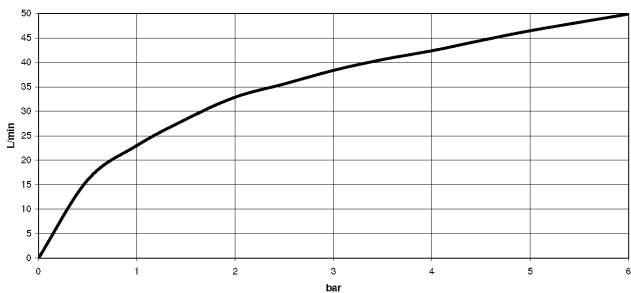

Codes & Standards

| | |
|---------------------------|--------------------------------|
| Scottish Water Byelaws | UK Water Supply Regulations |
|---------------------------|--------------------------------|



MEM Bath spout for wall mounting - Brushed Durabron (23kt Gold)

MEM

13 801 782

Certificates

WRAS_2203

Product version from 3/10/2014

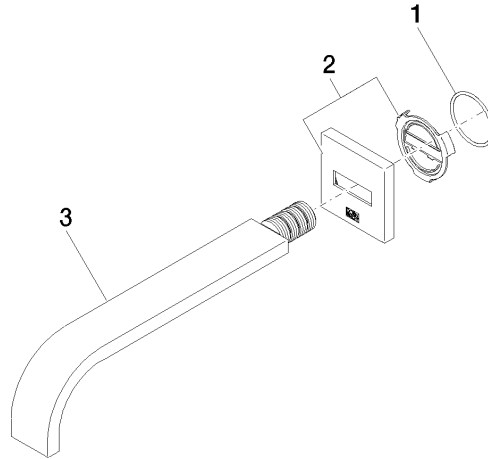



MEM Bath spout for wall mounting - Brushed Durabrass (23kt Gold)

MEM

13 801 782

Spare parts list

Product version from 3/10/2014

| No. | Item Number | Name | Quantity used | Delivery time |
|-----|-----------------|------|---------------|---------------|
| | 09 14 10 111 90 | seal | 3 | 2 |