

VAIA Bath spout for wall mounting - Chrome

13 801 809 Product version from 3/13/2017



- 200mm projection
- circular normal flow
- hole diameter 37 mm
- rosette Ø 60 mm
- 1/2" connection
- max. flow 21.5 l/min at 3 bar flow pressure
- WRAS

| | | |
|---|-------------------------------------|---------------|
|  | Chrome | 13 801 809-00 |
|  | Brushed Platinum | 13 801 809-06 |
|  | Platinum | 13 801 809-08 |
|  | Dark Chrome | 13 801 809-19 |
|  | Brushed Durabronze (23kt Gold) | 13 801 809-28 |
|  | Brushed Bronze | 13 801 809-42 |
|  | Brushed Champagne (22kt Gold) | 13 801 809-46 |
|  | Champagne (22kt Gold) | 13 801 809-47 |
|  | Brushed Dark Platinum | 13 801 809-99 |

Recommended miscellaneous



- Concealed wall elbow -**
- max. recess depth mm
 - min. recess depth mm

35 085 970 90

VAIA Bath spout for wall mounting - Chrome

13 801 809 Product version from 3/13/2017

mm [inches]

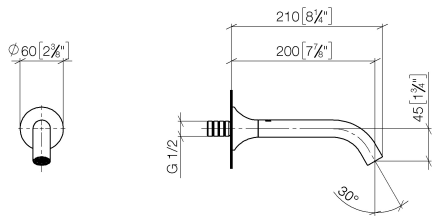

Flow rate chart

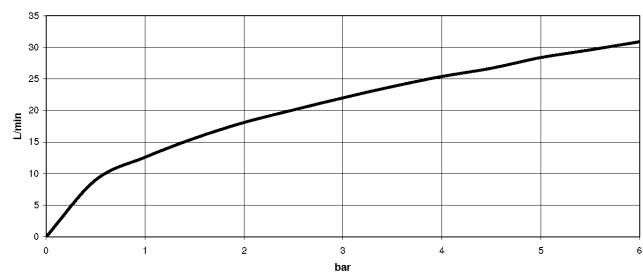

Codes & Standards

| | | | |
|----------|----------|------------------------|-----------------------------|
| DIN 4109 | ISO 3822 | Scottish Water Byelaws | UK Water Supply Regulations |
|----------|----------|------------------------|-----------------------------|

Ü-Zeichen



VAIA Bath spout for wall mounting - Chrome

13 801 809 Product version from 3/13/2017

Certificates

WRAS_2306

LGA_29

VAIA Bath spout for wall mounting - Chrome

13 801 809 Product version from 3/13/2017

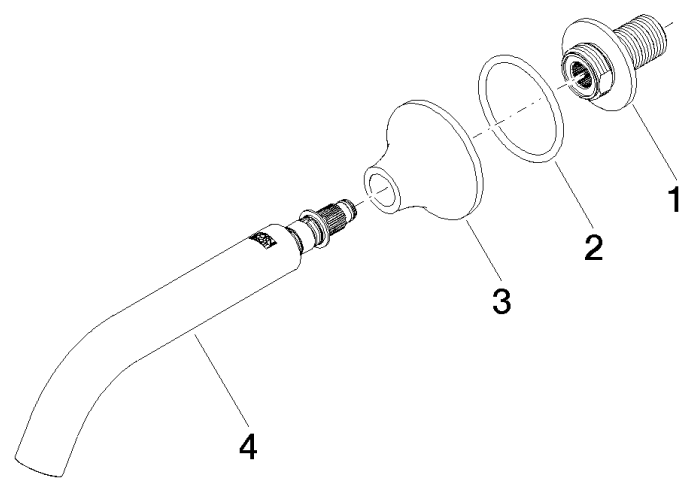

Spare parts list

| No. | Item Number | Name | Quantity used | Delivery time |
|-----|--------------------|---------|---------------|---------------|
| 1 | 09 24 03 269 90 | nipple | 1 | 2 |
| 2 | 09 14 10 084 90 | seal | 1 | 2 |
| 3 | 09 27 80 014-00 | rosette | 1 | 10 |
| 4 | 90 28 22 315 00-00 | spout | 1 | 10 |