







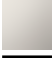

VAIA Bath spout for wall mounting - Brushed Champagne (22kt Gold)

13 801 809
Product version from 3/13/2017



- 200mm projection
- circular normal flow
- hole diameter 37 mm
- rosette Ø 60 mm
- 1/2" connection
- max. flow 21.5 l/min at 3 bar flow pressure
- WRAS

|   |                                |               |
|---|--------------------------------|---------------|
|  | Brushed Champagne (22kt Gold)  | 13 801 809-46 |
|  | Chrome                         | 13 801 809-00 |
|  | Brushed Platinum               | 13 801 809-06 |
|  | Platinum                       | 13 801 809-08 |
|  | Dark Chrome                    | 13 801 809-19 |
|  | Brushed Durabronze (23kt Gold) | 13 801 809-28 |
|  | Brushed Bronze                 | 13 801 809-42 |
|  | Champagne (22kt Gold)          | 13 801 809-47 |
|  | Brushed Dark Platinum          | 13 801 809-99 |

Recommended miscellaneous



- Concealed wall elbow -
  - max. recess depth mm
  - min. recess depth mm

35 085 970 90

VAIA Bath spout for wall mounting - Brushed Champagne (22kt Gold)

13 801 809
Product version from 3/13/2017

mm [inches]

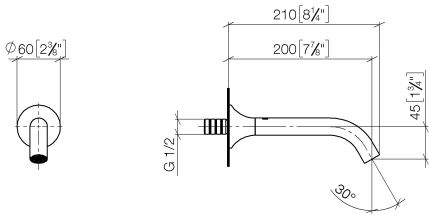

Flow rate chart



Codes & Standards

|          |          |                        |                             |
|----------|----------|------------------------|-----------------------------|
| DIN 4109 | ISO 3822 | Scottish Water Byelaws | UK Water Supply Regulations |
|----------|----------|------------------------|-----------------------------|

Ü-Zeichen



## VAIA Bath spout for wall mounting - Brushed Champagne (22kt Gold)

---

13 801 809 Product version from 3/13/2017

### Certificates

---

WRAS\_2306

LGA\_29

## VAIA Bath spout for wall mounting - Brushed Champagne (22kt Gold)

13 801 809 Product version from 3/13/2017

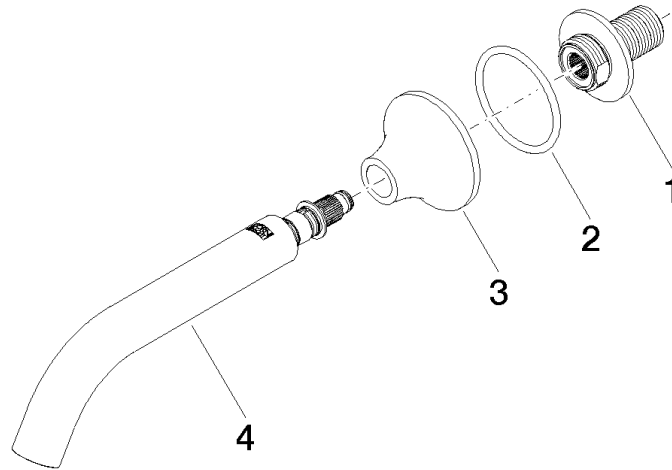

### Spare parts list

| No. | Item Number        | Name    | Quantity used | Delivery time |
|-----|--------------------|---------|---------------|---------------|
| 1   | 09 24 03 269 90    | nipple  | 1             | 2             |
| 2   | 09 14 10 084 90    | seal    | 1             | 2             |
| 3   | 09 27 80 014-46    | rosette | 1             | 30            |
| 4   | 90 28 22 315 00-46 | spout   | 1             | 30            |