

17 861 888



- 146mm projection
 - rigid, thermally insulated spout
 - laminar flow
 - height of mixer 288 mm
 - height up to laminar flow regulator 180 mm
 - hole diameter 35 mm
 - provides filtered, hot water up to 93°C
 - provides filtered, cold water
 - max. flow 2 l/min at 3 bar flow pressure
 - ready-to-use control unit for wall mounting (137mm x 159mm x 60mm)
 - electronic magnetic valve
 - 100-230 V, 50-60 Hz, 18 W power supply unit, incl. country-specific adapter set
 - lead-free
 - Spout ring cannot be removed.
 - This product can help a building meet the requirements of Green Building Rating Systems, e.g. LEED®, BREEAM®, DGNB
- A minimum flow pressure of 3 bar is necessary for the HOT & COLD WATER DISPENSER to work perfectly in conjunction with a hot water tank and filter.**
- In addition, the installation must be above a kitchen sink.**
- The filter cartridge must be changed every six months. The installation instructions contain further information for guidance.**
- Detailed planning information and technical data can be found at www.dornbracht.com/professional**

A minimum flow pressure of 3 bar is necessary for the HOT & COLD WATER DISPENSER to work perfectly in conjunction with a hot water tank and filter.

In addition, the installation must be above a kitchen sink.

The filter cartridge must be changed every six months. The installation instructions contain further information for guidance.

Detailed planning information and technical data can be found at www.dornbracht.com/professional

| | | |
|--|-------------------------------|---------------|
|  | Matte Black | 17 861 888-33 |
|  | Chrome | 17 861 888-00 |
|  | Brushed Platinum | 17 861 888-06 |
|  | Platinum | 17 861 888-08 |
|  | Durabrand (23kt Gold) | 17 861 888-09 |
|  | Dark Chrome | 17 861 888-19 |
|  | Brushed Durabrand (23kt Gold) | 17 861 888-28 |
|  | Brushed Champagne (22kt Gold) | 17 861 888-46 |
|  | Champagne (22kt Gold) | 17 861 888-47 |
|  | Brushed Chrome | 17 861 888-93 |
|  | Brushed Dark Platinum | 17 861 888-99 |

Required miscellaneous



Hot water tank incl. filter -

12 892 970 90

17 861 888

mm [inches]

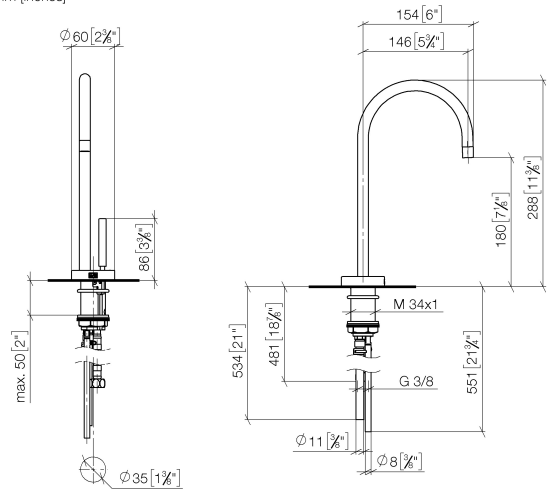

Flow rate chart



Codes & Standards

DIN 4109

Executive Order
no. 1007

ISO 3822

NSF372

NSF61

Ü-Zeichen



TARA HOT & COLD WATER DISPENSER - Matte Black

TARA

17 861 888

Certificates

GDV_0400

IAPMO_N-4

LGA_28

IAPMO_6

17 861 888

Product version from 5/27/2021 to 5/28/2022

Product version from 5/28/2022

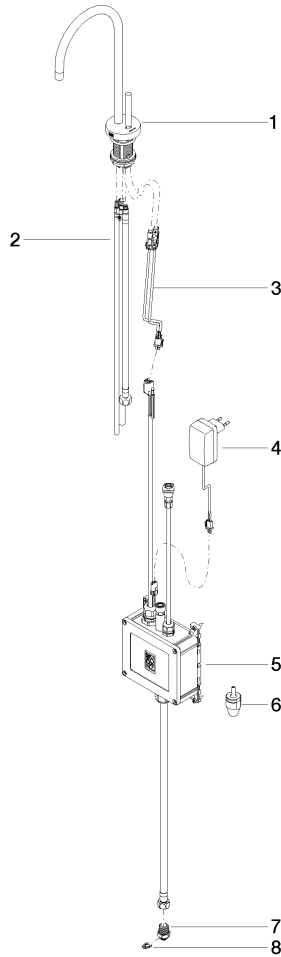



TARA HOT & COLD WATER DISPENSER - Matte Black

TARA

17 861 888

Spare parts list

Product version from 5/27/2021 to 5/28/2022

Product version from 5/28/2022