

## MEM Deck valve anti-clockwise closing hot - Brushed Platinum

MEM

20 000 783



- hole diameter 32 mm
- rosette 60 x 60 mm
- with hot marking
- WRAS 2103001

	Brushed Platinum	20 000 783-06
	Chrome	20 000 783-00
	Platinum	20 000 783-08
	Dark Chrome	20 000 783-19
	Brushed Durabronze (23kt Gold)	20 000 783-28
	Brushed Champagne (22kt Gold)	20 000 783-46
	Champagne (22kt Gold)	20 000 783-47
	Brushed Dark Platinum	20 000 783-99

20 000 783

mm [inches]

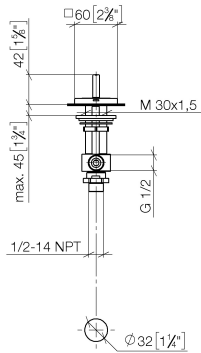

Flow rate chart

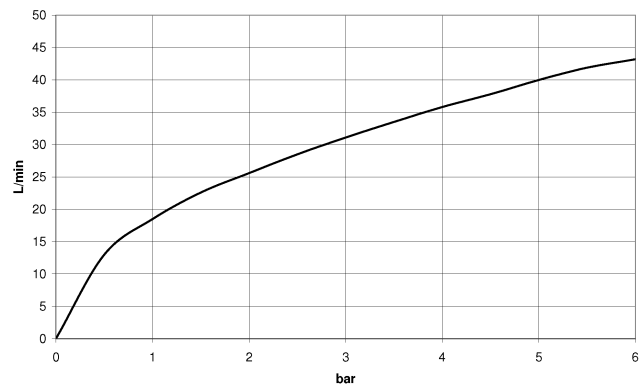

Codes & Standards

ASME A112.18.1

cUPC

Scottish Water  
Byelaws

UK Water Supply  
Regulations



## MEM Deck valve anti-clockwise closing hot - Brushed Platinum

---

MEM

20 000 783

### Certificates

---

IAPMO\_4976

WRAS\_2103

20 000 783

**Product version from 3/10/2014**

Parts for other  
finishes can be found  
here: [Chrome](#)

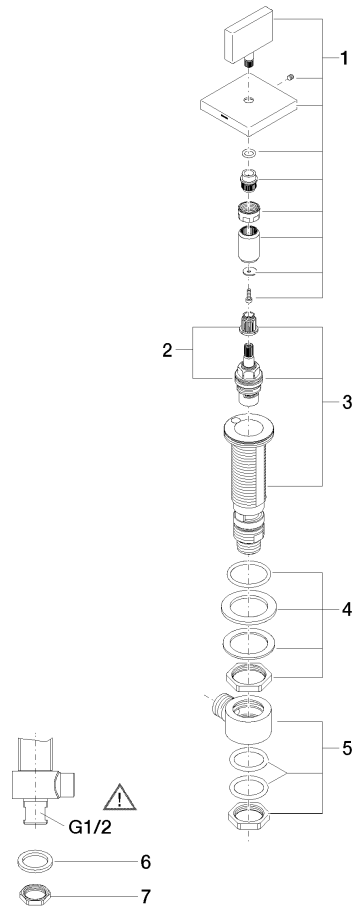



## MEM Deck valve anti-clockwise closing hot - Brushed Platinum

MEM

20 000 783

### Spare parts list

#### Product version from 3/10/2014

No.	Item Number	Name	Quantity used	Delivery time
	90 20 78 002 05-06	handle ( hot )	7	10