

20 000 980 Product version from 4/30/2013

- hole diameter valve 32 mm
- rosette 60 x 60 mm



20 000 980 Product version from 4/30/2013

mm [inches]

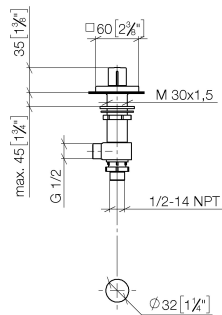

### Flow rate chart

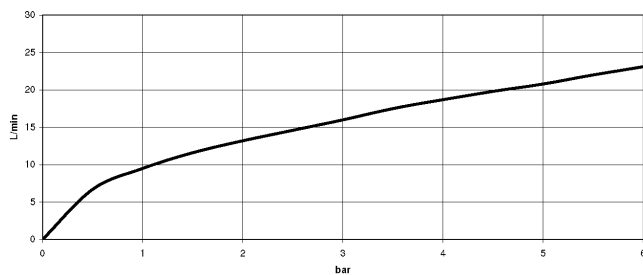

### Codes & Standards

ASME A112.18.1

cUPC

EN 200

NSF372

### VA-Zeichen



SYMETRICS Deck valve anti-clockwise closing cold or hot - Chrome

SYMETRICS

20 000 980 Product version from 4/30/2013

Certificates and sustainability

ETA_18	IAPMO_4976	IAPMO_6
--------	------------	---------

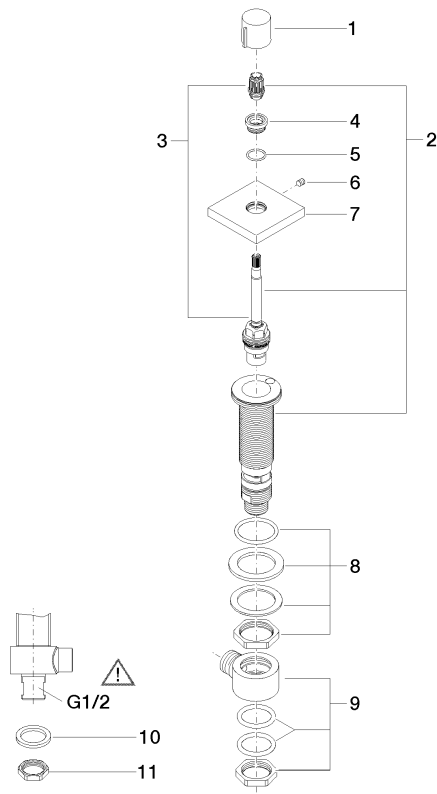

## Spare parts list

No.	Item Number	Name	Quantity used	Delivery time
11	09 23 10 012 90	nut	1.00	2
10	09 30 11 059 90	disc	1.00	2
2	90 17 11 045 04 90	side panel	1.00	2
7	09 27 98 014-00	rosette	1.00	10
9	04 17 11 023 10 90	distributor	1.00	2
3	90 90 03 204 00 90	top	1.00	2
8	04 23 10 032 78 90	fixing set	1.00	2
1	09 20 98 001-00	handle	1.00	10
5	09 14 10 017 90	seal	1.00	2
4	09 12 12 043-00	base	1.00	10
6	90 31 11 004 00 90	pin	1.00	2