

Angle valve - Chrome

SERIES SPECIFIC

22 901 979 Product version up to 5/27/2021



- rosette Ø 55 mm
- hose covering 200mm, for shortening
- WRAS

	Chrome	22 901 979-00
	Brushed Platinum	22 901 979-06
	Platinum	22 901 979-08
	Durabrand (23kt Gold)	22 901 979-09
	Dark Chrome	22 901 979-19
	Brushed Durabrand (23kt Gold)	22 901 979-28
	Matte Black	22 901 979-33
	Brushed Champagne (22kt Gold)	22 901 979-46
	Champagne (22kt Gold)	22 901 979-47
	Brushed Chrome	22 901 979-93
	Brushed Dark Platinum	22 901 979-99

22 901 979 Product version up to 5/27/2021

mm [inches]



Flow rate chart



Codes & Standards

Scottish Water Byelaws	UK Water Supply Regulations
---------------------------	--------------------------------



Angle valve - Chrome

SERIES SPECIFIC

22 901 979 Product version up to 5/27/2021

Certificates and sustainability

WRAS_2205

Parts for other
finishes can be found
here: Brushed
Platinum

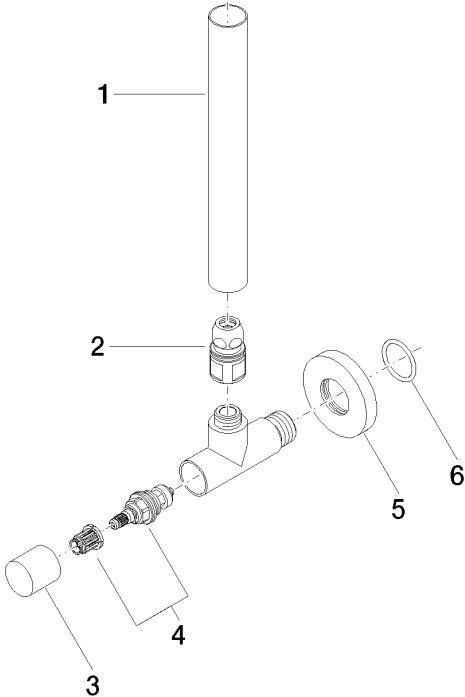

Spare parts list

No.	Item Number	Name	Quantity used	Delivery time
	5 09 27 22 015-00	rosette	1.00	10
	6 09 14 10 093 90	seal	1.00	2
	2 90 24 03 276 00 90	conversion kit	1.00	2
	3 09 20 22 001-00	handle	1.00	10
	1 09 28 22 020-00	pipe	1.00	10
	4 90 90 03 006 00 90	top	1.00	2