

Rain shower for surface-mounted ceiling installation with light 300 mm -  
Brushed Dark Brass

SERIES SPECIFIC

28 032 970 Product version from 5/1/2022



- rain shower Ø 300 mm
  - PURE RAIN, max. flow rate 12 l/min (at 3 bar)
  - PURIFY RAIN, max. flow rate 6 l/min (at 3 bar)
  - with anti-scale system
- Technical data:**
- Distance to ceiling from bottom edge of shower 40 mm
- Ceiling module power supply**
- 350mA (CC)
- Spot lighting**
- LED colour temperature approx. 3000 K
  - Bulbs protected against splashing water
- Electric:**
- Technology: LED, not dimmable
  - Provided by customer: Light switch
  - Contains energy efficiency class bulbs
- Planning tips:**
- Not suitable for outdoor use.
  - Not suitable for use in a steam room.
  - Not suitable for use in chlorinated or salty environments.
  - Comply with the protection zone regulations as defined in DIN VDE 0100, Part 701 (IEC 60364-7-701).
  - WRAS

	Brushed Dark Brass	28 032 970-39
	Chrome	28 032 970-00
	Brushed Platinum	28 032 970-06
	Platinum	28 032 970-08
	Dark Chrome	28 032 970-19
	Light Gold	28 032 970-26
	Brushed Light Gold	28 032 970-27
	Brushed Durabrass (23kt Gold)	28 032 970-28
	Matte Black	28 032 970-33
	Brushed Bronze	28 032 970-42
	Brushed Champagne (22kt Gold)	28 032 970-46
	Champagne (22kt Gold)	28 032 970-47
	Brushed Chrome	28 032 970-93
	Brushed Dark Platinum	28 032 970-99

## Rain shower for surface-mounted ceiling installation with light 300 mm - Brushed Dark Brass

SERIES SPECIFIC

28 032 970 Product version from 5/1/2022  
mm [inches]



### Flow rate chart



### Codes & Standards

DIN 4109

ISO 3822

Scottish Water  
Byelaws

UK Water Supply  
Regulations

Ü-Zeichen



Rain shower for surface-mounted ceiling installation with light 300 mm -  
Brushed Dark Brass

SERIES SPECIFIC

28 032 970    Product version from 5/1/2022

Certificates and sustainability

LGA\_38

WRAS\_240502

## Rain shower for surface-mounted ceiling installation with light 300 mm - Brushed Dark Brass

SERIES SPECIFIC

28 032 970 Product version from 5/1/2022

Parts for other  
finishes can be found  
here: [Chrome](#)

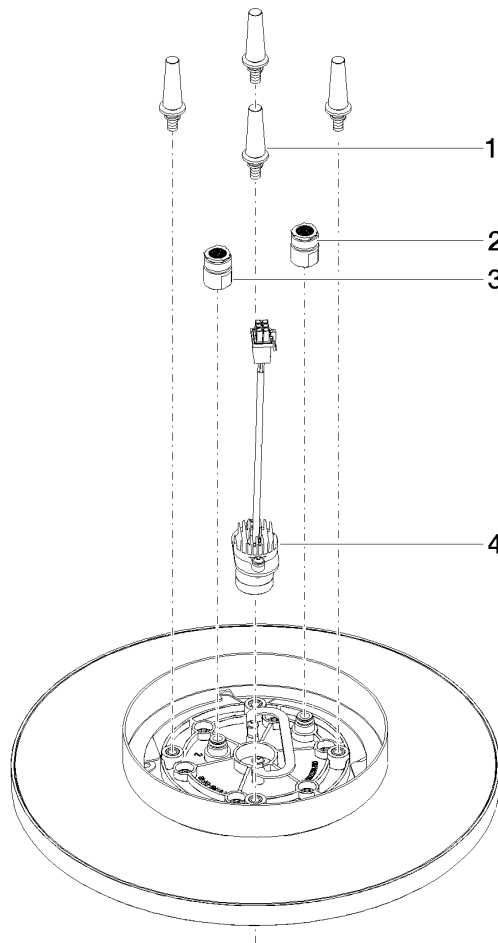

### Spare parts list

No.	Item Number	Name	Quantity used	Delivery time
4	90 10 01 225 00 90	electronic accessories	1.00	2
3	90 24 03 309 00 90	connection	1.00	2
2	90 24 03 309 01 90	connection	1.00	2
1	90 17 20 263 00 90	fixing set	1.00	2