

MADISON Rain shower with wall fixing FlowReduce 200 mm - Brushed Dark Brass

MADISON

28 544 977 Product version from 7/1/2025









- rain shower Ø 200 mm
- rain flow
- max. flow 7 l/min
- Function from: 6.5 l/min
- with anti-scale system

Technical data:

- 435mm projection
- rosette Ø 55 mm
- 1/2" connection

Notes:

- This product can help a building meet the requirements of Green Building Rating Systems, e.g. LEED®, BREEAM®, DGNB

	Brushed Dark Brass	28 544 977-39
	Chrome	28 544 977-00
	Brushed Platinum	28 544 977-06
	Platinum	28 544 977-08
	Durabrass (23kt Gold)	28 544 977-09
	Brushed Durabrass (23kt Gold)	28 544 977-28
	Brushed Dark Platinum	28 544 977-99

MADISON Rain shower with wall fixing FlowReduce 200 mm - Brushed Dark Brass

MADISON

28 544 977 Product version from 7/1/2025
mm [inches]



Flow rate chart

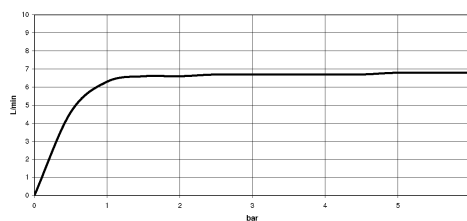

Codes & Standards

DIN 4109

ISO 3822

Scottish Water
Byelaws

UK Water Supply
Regulations

Ü-Zeichen



MADISON Rain shower with wall fixing FlowReduce 200 mm - Brushed Dark
Brass

MADISON

28 544 977 Product version from 7/1/2025

Certificates and sustainability

LGA_38

WRAS_250102

MADISON Rain shower with wall fixing FlowReduce 200 mm - Brushed Dark Brass

MADISON

28 544 977 Product version from 7/1/2025
Parts for other
finishes can be found
here: Chrome

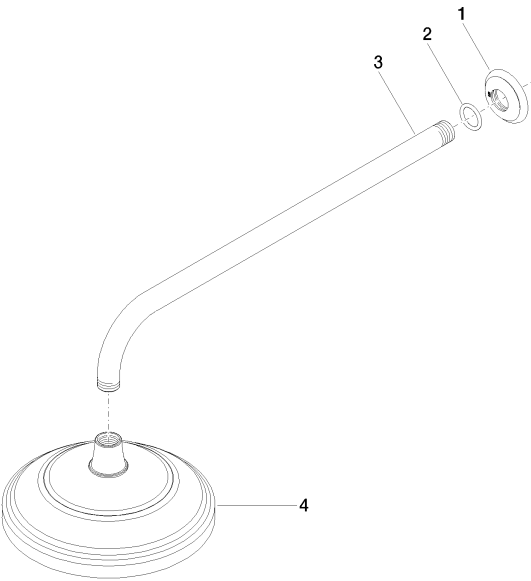

Spare parts list

No.	Item Number	Name	Quantity used	Delivery time
3	09 11 03 017-39	connection	1.00	-
Spare part can no longer be ordered, please order the replacement item				
2	90 14 10 026 00 90	seal	1.00	2
1	09 27 35 003-39	rosette	1.00	-
Spare part can no longer be ordered, please order the replacement item				
4	90 12 05 038 20-39	shower	1.00	30