

IMO Single-lever basin mixer with pop-up waste - Brushed Durabrand (23kt Gold)







IMO

33 500 670



- 130mm projection
- fixed spout
- rectangular, air-enriched flow
- height of mixer 154 mm
- height up to aerator 80 mm
- hole diameter 35 mm
- 2x screw-in M 10 x 1 pressure hose, leak-tested
- max. flow 7 l/min
- lead-free
- This product can help a building meet the requirements of Green Building Rating Systems, e.g. LEED®, BREEAM®, DGNB
- WRAS 240202005

Only suitable for basins with an overflow.

| | | |
|--|-------------------------------|---------------|
|  | Brushed Durabrand (23kt Gold) | 33 500 670-28 |
|  | Chrome | 33 500 670-00 |
|  | Brushed Platinum | 33 500 670-06 |
|  | Platinum | 33 500 670-08 |
|  | Brushed Chrome | 33 500 670-93 |
|  | Brushed Dark Platinum | 33 500 670-99 |

IMO Single-lever basin mixer with pop-up waste - Brushed Durabron (23kt Gold)

IMO

33 500 670
mm [inches]

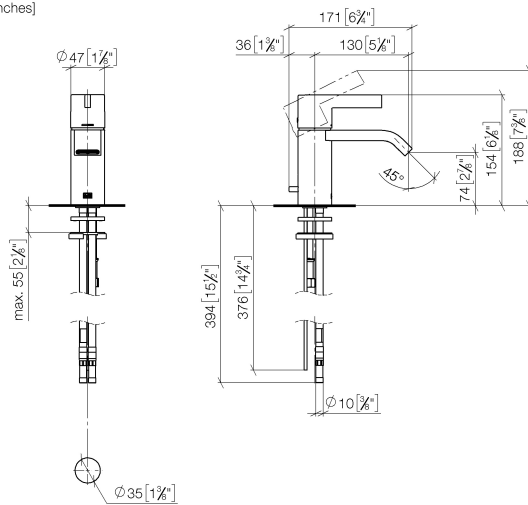

Flow rate chart

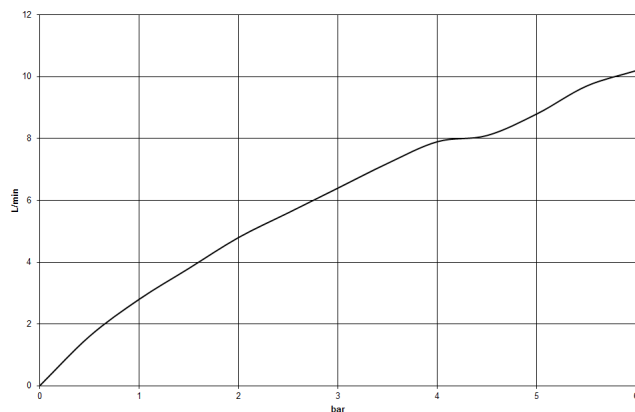

Codes & Standards

DIN 4109

EN 817

Executive Order
no. 1007

ISO 3822

Scottish Water
Byelaws

UK Water Supply
Regulations

Ü-Zeichen

VA-Zeichen



IMO Single-lever basin mixer with pop-up waste - Brushed Durabrass (23kt Gold)

IMO

| | | | | |
|--------------|--------|-------------|-----------|--------|
| 33 500 670 | | | | |
| Certificates | | | | |
| GDV_0400 | LGA_19 | WRAS_240202 | WRAS_1806 | ETA_19 |

IMO Single-lever basin mixer with pop-up waste - Brushed Durabronz (23kt Gold)

IMO

33 500 670

Product version up to 10/10/2018

Product version from 10/10/2018 to 5/10/2021

Product version from 5/10/2021

Parts for other
finishes can be found
here: [Chrome](#)



22 ———— Revised for 14.11.2021 09:4



IMO Single-lever basin mixer with pop-up waste - Brushed Durabrass (23kt Gold)

IMO

33 500 670

Spare parts list

Product version up to 10/10/2018

Product version from 10/10/2018 to 5/10/2021

Product version from 5/10/2021

| No. | Item Number | Name | Quantity used | Delivery time |
|-----|--------------------|------|---------------|---------------|
| | 90 31 20 087 00-28 | plug | 24 | 20 |