





# DORNBRACHT YARRE Single-lever basin mixer with pop-up waste - Chrome

33 501 832



- 120mm projection
- fixed spout
- circular, air-enriched flow
- height of mixer 126 mm
- height up to aerator 80 mm
- hole diameter 35 mm
- 2x screw-in M 8 x 1 pressure hose, leak-tested
- max. flow 6.8 l/min
- WRAS 240104004

|  |            |               |
|--|------------|---------------|
|  | Chrome     | 33 501 832-00 |
|  | Soft Black | 33 501 832-69 |



DORNBRACHT YARRE Single-lever basin mixer with pop-up waste - Chrome

33 501 832

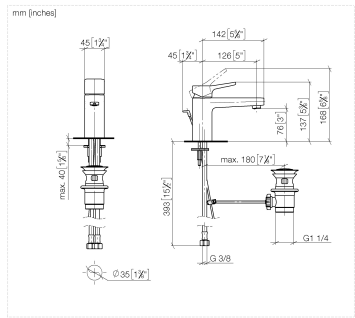

Flow rate chart

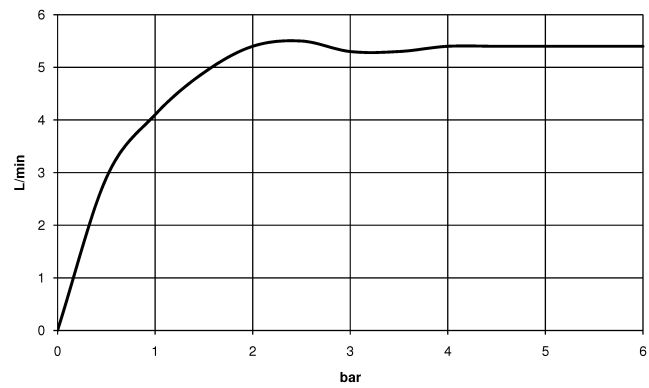

Codes & Standards

DIN 4109

ISO 3822

Scottish Water  
Byelaws

UK Water Supply  
Regulations

Ü-Zeichen

XP P 41-280



## DORNBACHT YARRE Single-lever basin mixer with pop-up waste - Chrome

---

33 501 832

### Certificates

---

AbP\_10

WRAS\_240104

ACS\_23 ACC NY

## DORNBRAUCHT YARRE Single-lever basin mixer with pop-up waste - Chrome

33 501 832

### Product version from 1/1/2023

Parts for other  
finishes can be found  
here: Soft Black

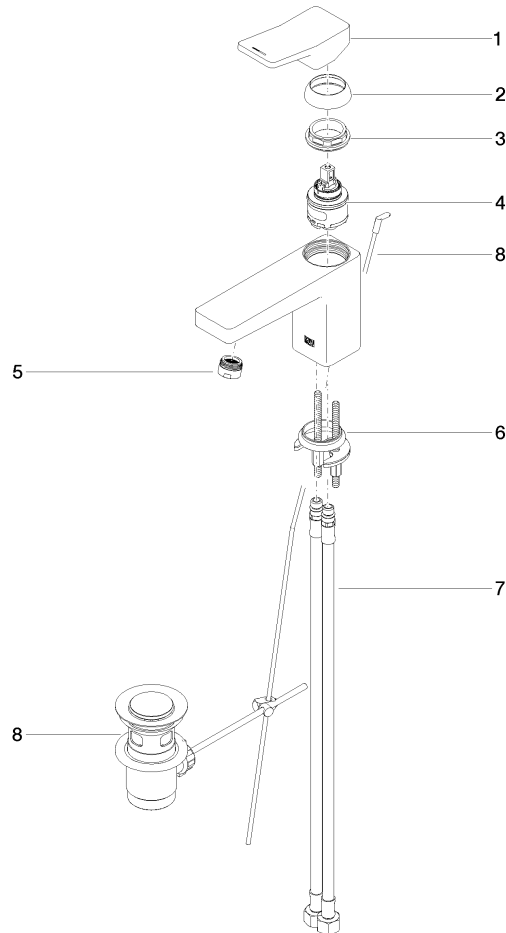



## DORNBACHT YARRE Single-lever basin mixer with pop-up waste - Chrome

---

33 501 832

### Spare parts list

#### Product version from 1/1/2023

| No. | Item Number        | Name   | Quantity used | Delivery time |
|-----|--------------------|--------|---------------|---------------|
|     | 90 20 83 004 00-00 | handle | 9             | 2             |