



DORNBRACHT YARRE Single-lever basin mixer with raised base without pop-up waste - Soft Black

DORNBRACHT YARRE

33 537 832    Product version from 1/1/2023



- 180mm projection
- fixed spout
- circular, air-enriched flow
- height of mixer 297 mm
- height up to aerator 236 mm
- hole diameter 35 mm
- 2x screw-in M 8 x 1 pressure hose, leak-tested
- max. flow 6.8 l/min
- WRAS

|   |            |               |
|---|------------|---------------|
|  | Soft Black | 33 537 832-69 |
|  | Chrome     | 33 537 832-00 |

# DORNBRAUCHT YARRE Single-lever basin mixer with raised base without pop-up waste - Soft Black

DORNBRAUCHT  
YARRE

33 537 832 Product version from 1/1/2023  
mm [inches]

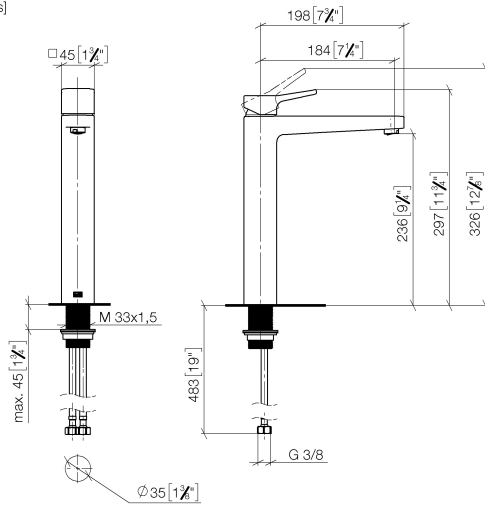

Flow rate chart



## Codes & Standards

DIN 4109

EN 817

ISO 3822

Scottish Water  
Byelaws

UK Water Supply  
Regulations

Ü-Zeichen

XP P 41-280



DORNBRACHT YARRE Single-lever basin mixer with raised base without pop-up waste - Soft Black

DORNBRACHT  
YARRE

33 537 832 Product version from 1/1/2023

Certificates and sustainability

|        |               |             |                 |
|--------|---------------|-------------|-----------------|
| AbP_10 | ACS_23 ACC NY | WRAS_240104 | DVGW_DW-6506DP0 |
|--------|---------------|-------------|-----------------|

## DORNBACHT YARRE Single-lever basin mixer with raised base without pop-up waste - Soft Black

DORNBACHT  
YARRE

33 537 832 Product version from 1/1/2023

Parts for other  
finishes can be found  
here: [Chrome](#)

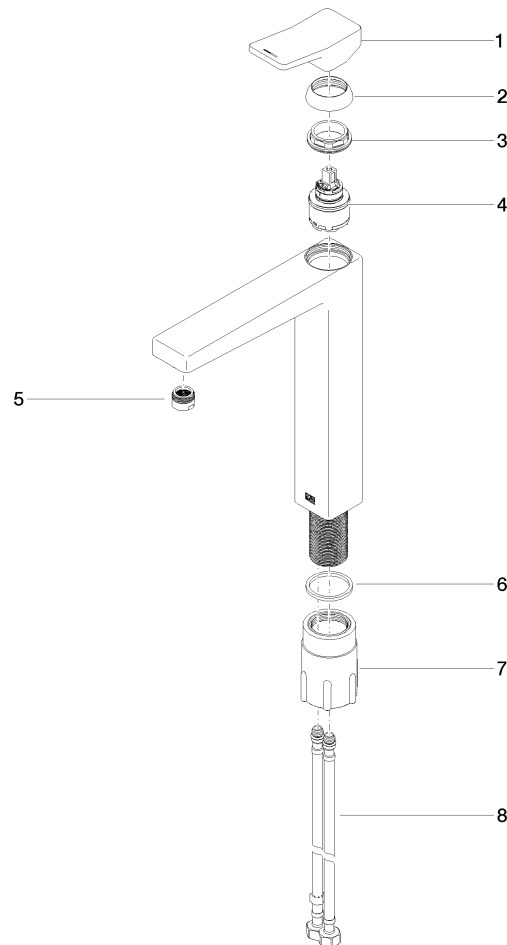

### Spare parts list

| No. | Item Number        | Name       | Quantity used | Delivery time |
|-----|--------------------|------------|---------------|---------------|
| 6   | 90 14 05 082 00 90 | seal       | 1.00          | 2             |
| 1   | 90 20 83 004 00-69 | handle     | 1.00          | 2             |
| 3   | 90 23 10 140 00 90 | nut        | 1.00          | 2             |
| 5   | 90 23 01 177 00-69 | aerator    | 1.00          | 2             |
| 8   | 90 30 04 115 00 90 | hose       | 1.00          | 2             |
| 2   | 90 21 02 400 00-69 | cover      | 1.00          | 2             |
| 7   | 90 30 11 505 00 90 | fixing set | 1.00          | 2             |
| 4   | 90 15 05 502 00 90 | cartridge  | 1.00          | 2             |