



- 225mm projection
- pivotable spout 130°
- air-enriched flow and spray flow
- height of mixer 167 mm
- height up to aerator 137 mm
- hole diameter 35 mm
- fabric braided hose 1500 mm
- max. flow 8.3 l/min at 3 bar flow pressure
- lead-free
- This product can help a building meet the requirements of Green Building Rating Systems, e.g. LEED®, BREEAM®, DGNB

Intrinsic protection against back flow.

Recommended miscellaneous

	Dispenser without rosette - Brushed Platinum	82 424 970-06

Recommended miscellaneous

	Strainer waste with control handle - Brushed Platinum	10 712 970-06

33 870 760 Product version from 1/1/2014 to 1/1/2019

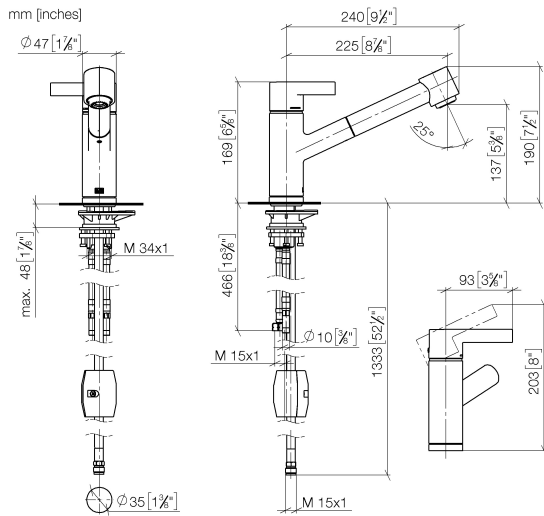

Flow rate chart



Codes & Standards

DIN 4109	EN 1717	EN 817	Executive Order no. 1007
ISO 3822	Ü-Zeichen	VA-Zeichen	



ENO Single-lever mixer Pull-out with spray function - Brushed Platinum

ENO

33 870 760 Product version from 1/1/2014 to 1/1/2019

Certificates and sustainability

ETA_20	LGA_19	GDV_0400	Belgaqua_22_277_2
--------	--------	----------	-------------------

This exploded view diagram illustrates the assembly of a mechanical device, likely a pump or valve. The components are numbered as follows:

- 1**: Top cylindrical housing with an inlet/outlet port.
- 2**: O-ring for the top housing.
- 3**: Flange or seal ring.
- 4**: O-ring for the flange.
- 5**: Small circular gasket or seal.
- 6**: Larger circular gasket or seal.
- 7**: Small O-ring.
- 8**: Small cylindrical component, possibly a pin or plug.
- 9**: Small cylindrical component, possibly a pin or plug.
- 10**: Main vertical cylindrical body.
- 11**: Small cylindrical component, possibly a pin or plug.
- 12**: Small cylindrical component, possibly a pin or plug.
- 13**: Small cylindrical component, possibly a pin or plug.
- 14**: Small cylindrical component, possibly a pin or plug.
- 15**: Flange or seal ring.
- 16**: O-ring for the flange.
- 17**: Flange or seal ring.
- 18**: O-ring for the flange.
- 19**: Flange or seal ring.
- 20**: O-ring for the flange.
- 21**: Flange or seal ring.
- 22**: Bracket or support structure.
- 23**: Flange or seal ring.
- 24**: Flange or seal ring.
- 25**: Flange or seal ring.
- 26**: Small cylindrical component, possibly a pin or plug.
- 27**: Small cylindrical component, possibly a pin or plug.
- 28**: Small cylindrical component, possibly a pin or plug.

Spare parts list

No.	Item Number	Name	Quantity used	Delivery time
15	09 14 10 001 90	seal	1.00	2
23	09 18 40 090 90	sleeve	1.00	2
6	09 24 04 270 90	nut	1.00	2
5	09 14 10 102 90	seal	1.00	2
7	09 14 10 031 90	seal	1.00	2
11	09 18 40 099 90	sleeve	1.00	2
4	09 28 30 012-06	cover	1.00	10
20	09 27 76 001-06	rosette	1.00	10
24	04 30 04 029 00 90	hose	1.00	2
16	09 30 30 113 20 90	screw	1.00	2
22	04 23 10 044 02 90	fixing set	1.00	2
9	90 15 05 064 00 90	cartridge	1.00	2
1	09 20 76 001-06	handle	1.00	10
18	09 28 10 144 90	ring	1.00	2
25	04 21 50 005 00 90	accessories	1.00	2
17	09 14 15 029 90	ring	2.00	2
21	04 30 04 018 00 90	hose	2.00	60
26	09 23 01 131 90	back-flow preventer	1.00	2
19	09 14 10 034 90	seal	1.00	2
13	09 23 01 039 90	sieve	1.00	2
10	09 19 76 001-06	sleeve	1.00	10
2	90 31 20 109 00 90	plug	1.00	2
27	90 14 20 019 00 90	seal	1.00	2
3	90 31 11 030 00 90	pin	1.00	2
28	90 30 09 031 00 90	key	1.00	2
8	90 28 10 148 00 90	accessories	1.00	2
14	90 12 11 098 00-06	shower	1.00	10
12	90 30 02 062 00-06	hose	1.00	10