

## SERENITY SKY Concealed ceiling installation box -

SERIES-VARIOUS

35 770 970 90 Product version from 9/1/2024



- concealed rough parts
- flush-mounted reflection box, 662 x 482 mm, RAL 9003, Signal White
- max. recess depth 590 mm
- min. recess depth 150 mm
- 2x female thread 1/2" connections
- weight 15kg
- Recommended control element: xTool
- Not suitable for use in a steam room.

### Recommended miscellaneous

#### Leak protection 1/2" -

12 010 970 90

- This article is needed 2x.



35 770 970 90 Product version from 9/1/2024

mm [inches]

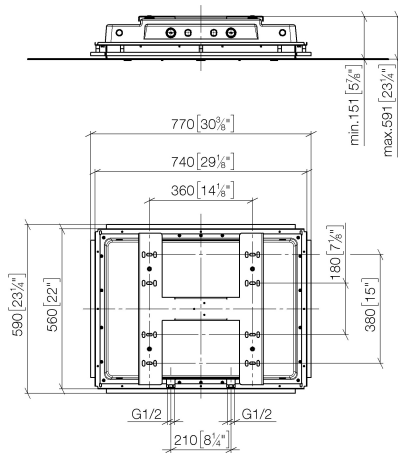

## Codes & Standards

Scottish Water  
Byelaws

UK Water Supply  
Regulations

## Certificates and sustainability

WRAS\_250102

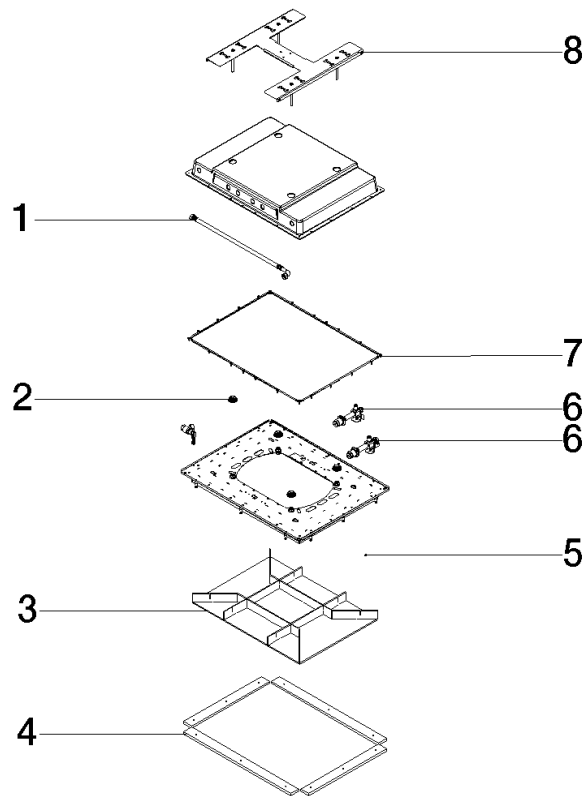

## Spare parts list

No.	Item Number	Name	Quantity used	Delivery time
3	90 91 42 195 01 90	lid	1.00	2
4	90 18 30 020 00 90	sleeve	1.00	2
8	90 17 20 304 00 90	holder	1.00	2
6	90 17 20 308 00 90	connection	2.00	2
7	90 14 03 194 00 90	seal	1.00	2
1	90 30 04 099 00 90	hose	1.00	2
2	91 31 20 530 00 90	nipple set	4.00	2
5	91 30 30 194 00 90	screw	2.00	2