







CL.1 Wall valve clockwise closing cold 1/2" - Brushed Platinum

CL.1

36 617 706    Product version up to 10/14/2020



- with WAVES structure
- rosette 60 x 60 mm
- with cold marking
- head part with cut-to-length spindle and sleeve
- WRAS

	Brushed Platinum	36 617 706-06
	Chrome	36 617 706-00
	Dark Chrome	36 617 706-19
	Brushed Champagne (22kt Gold)	36 617 706-46
	Champagne (22kt Gold)	36 617 706-47
	Brushed Dark Platinum	36 617 706-99

Required miscellaneous

	<b>Wall valve 1/2" -</b> •max. recess depth 150 mm •min. recess depth 105 mm	35 607 970 90
---	--	---------------



CL.1 Wall valve clockwise closing cold 1/2" - Brushed Platinum

CL.1

36 617 706    Product version up to 10/14/2020

mm [inches]



Codes & Standards

ASME A112.18.1	cUPC	DIN 4109	EN 200
ISO 3822	Scottish Water Byelaws	UK Water Supply Regulations	Ü-Zeichen

Certificates and sustainability

DVGW_DW-6501DN0	LGA_29	WRAS_2010	LGA_29	IAPMO_4976 (
-----------------	--------	-----------	--------	--------------

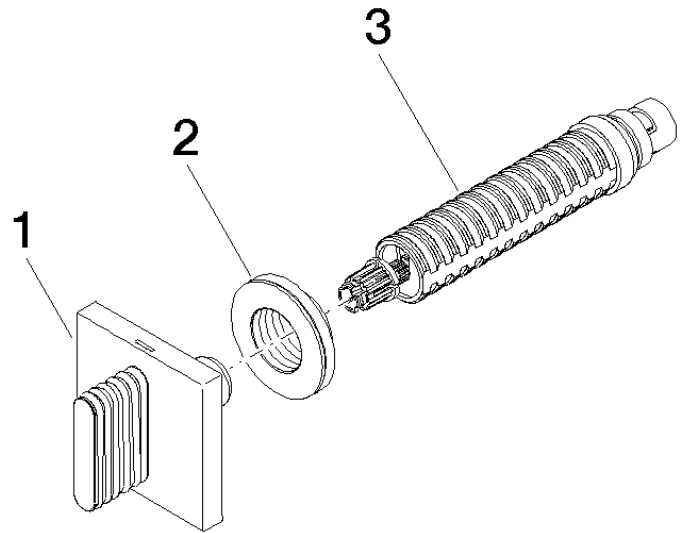

Spare parts list

No.	Item Number	Name	Quantity used	Delivery time
1	90 20 70 055 02-06	handle ( cold )	1.00	10
3	90 90 03 143 00 90	top	1.00	2
2	09 21 02 108 90	disc	1.00	60