

MEM Wall-mounted basin mixer without pop-up waste - Brushed Durabrass (23kt Gold)

MEM

36 707 782 Product version from 3/10/2014 to 10/27/2020



- 170mm projection
- fixed spout
- rectangular, air-enriched flow
- hole diameter valve 40 mm
- hole diameter spout 40 mm
- individual rosettes 60 x 60 mm
- max. flow 5.7 l/min
- lead-free
- This product can help a building meet the requirements of Green Building Rating Systems, e.g. LEED®, BREEAM®, DGNB
- WRAS

| | | |
|-----------------------------------------------------------------------------------|-------------------------------|---------------|
|  | Brushed Durabrass (23kt Gold) | 36 707 782-28 |
|  | Chrome | 36 707 782-00 |
|  | Brushed Platinum | 36 707 782-06 |
|  | Platinum | 36 707 782-08 |
|  | Dark Chrome | 36 707 782-19 |
|  | Brushed Champagne (22kt Gold) | 36 707 782-46 |
|  | Champagne (22kt Gold) | 36 707 782-47 |
|  | Brushed Dark Platinum | 36 707 782-99 |

Required miscellaneous



- Concealed wall-mounted mixer centred spout -** 35 700 970 90
- max. recess depth 150 mm
 - min. recess depth 110 mm

Required miscellaneous



- Concealed wall-mounted mixer variable positioning -** 35 720 970 90
- min. recess depth 110 mm
 - max. recess depth 150 mm

MEM Wall-mounted basin mixer without pop-up waste - Brushed Durabronss (23kt Gold)

MEM

36 707 782 Product version from 3/10/2014 to 10/27/2020
mm [inches]

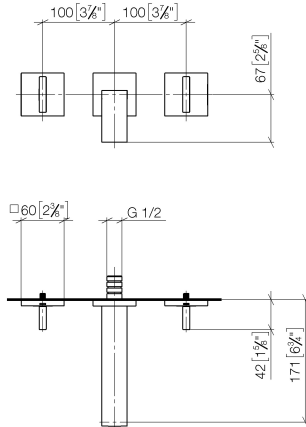

Flow rate chart



Codes & Standards

| | | | |
|-----------------------------|-----------|------------|------------------------|
| DIN 4109 | EN 200 | ISO 3822 | Scottish Water Byelaws |
| UK Water Supply Regulations | Ü-Zeichen | VA-Zeichen | |



MEM Wall-mounted basin mixer without pop-up waste - Brushed Durabrass
(23kt Gold)

MEM

36 707 782 Product version from 3/10/2014 to 10/27/2020

Certificates and sustainability

| | | |
|--------|-----------|--------|
| LGA_18 | WRAS_2204 | ETA_19 |
|--------|-----------|--------|

MEM Wall-mounted basin mixer without pop-up waste - Brushed Durabronz (23kt Gold)

MEM

36 707 782 Product version from 3/10/2014 to 10/27/2020

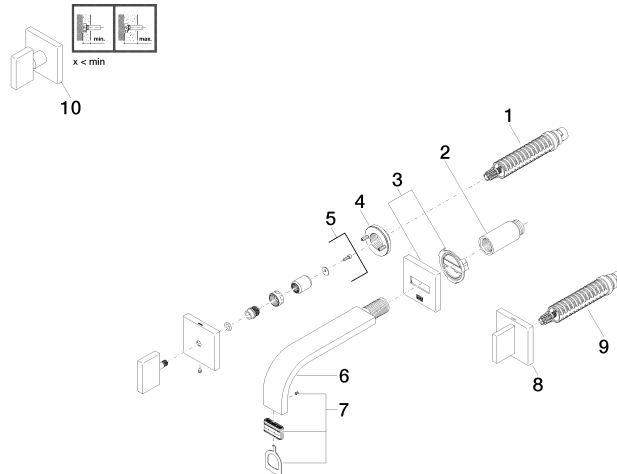

Spare parts list

| No. | Item Number | Name | Quantity used | Delivery time |
|-----|--------------------|-----------------|---------------|---------------|
| 4 | 90 21 02 108 00 90 | disc | 2.00 | 2 |
| 3 | 90 27 78 035 00-28 | rosette | 1.00 | 20 |
| 6 | 04 28 22 150 10-28 | spout | 1.00 | 20 |
| 2 | 09 24 03 081 10 90 | extension | 1.00 | 2 |
| 5 | 90 20 78 002 07-28 | handle (hot) | 1.00 | 20 |
| 9 | 90 90 03 157 00 90 | top | 1.00 | 2 |
| 7 | 90 29 03 109 00 90 | aerator | 1.00 | 2 |
| 8 | 90 20 78 002 06-28 | handle (cold) | 1.00 | 20 |
| 1 | 90 90 03 156 00 90 | top | 1.00 | 2 |
| 10 | 90 20 78 002 01-28 | handle | 1.00 | 20 |