

META Thermostat module with 3 valves - Champagne (22kt Gold)

META

ST 060 100 3660



- cover plate Ø 124 mm
- rosette Ø 60 mm
- temperature control handle with safety limit stop at 38°C
- thermostat cartridge
- 3x head part with cut-to-length spindle and sleeve

	Champagne (22kt Gold)	ST 060 100 3660-47
	Chrome	ST 060 100 3660-00
	Brushed Platinum	ST 060 100 3660-06
	Platinum	ST 060 100 3660-08
	Dark Chrome	ST 060 100 3660-19
	Light Gold	ST 060 100 3660-26
	Brushed Light Gold	ST 060 100 3660-27
	Matte Black	ST 060 100 3660-33
	Brushed Bronze	ST 060 100 3660-42
	Brushed Champagne (22kt Gold)	ST 060 100 3660-46
	Brushed Chrome	ST 060 100 3660-93
	Brushed Dark Platinum	ST 060 100 3660-99

Individual components of this set

You need the following components for this set



3x 36 607 660-47



1x 36 503 979-47









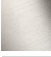

META Thermostat module with 3 valves - Champagne (22kt Gold)

META

ST 060 100 3660

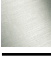
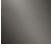

- rosette Ø 60 mm
- head part with cut-to-length spindle and sleeve

	Champagne (22kt Gold)	36 607 660-4
	Chrome	36 607 660-0
	Brushed Platinum	36 607 660-0
	Platinum	36 607 660-0
	Dark Chrome	36 607 660-1
	Light Gold	36 607 660-2
	Brushed Light Gold	36 607 660-2
	Matte Black	36 607 660-3
	Brushed Bronze	36 607 660-4
	Brushed Champagne (22kt Gold)	36 607 660-4
	Brushed Chrome	36 607 660-9
	Brushed Dark Platinum	36 607 660-9

ST 060 100 3660

.7  
—  
:0  
—  
:6  
—  
:8  
—  
9  
—  
:6  
—  
:7  
—  
:3  
—  
.2  
—  
6  
—  
:3  
—  
:9  
—

Required miscellaneous



- Wall valve 1/2" -**
  - min. recess depth 75 mm
  - max. recess depth 145 mm

35 607 970 90

ST 060 100 3660

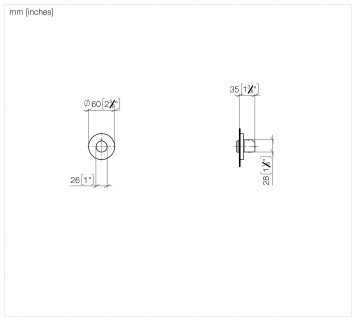



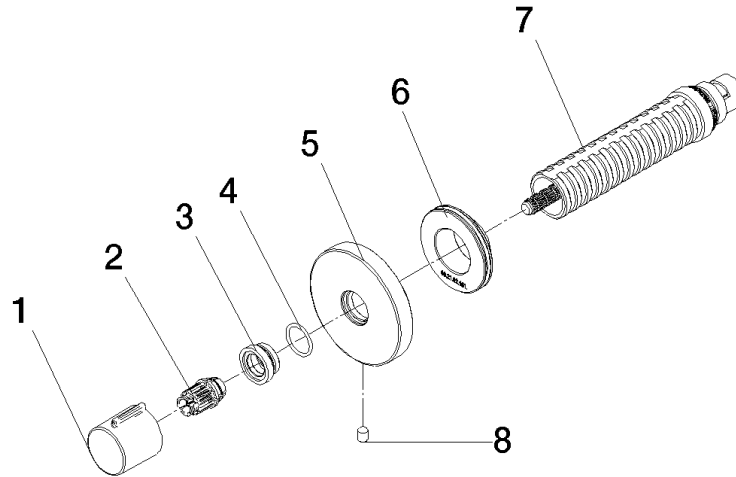

## Spare parts list

Error: Subreport could not be shown.