



SYMETRICS xTOOL Thermostat module with 1 valve - Brushed Champagne
(22kt Gold)

CL.1

ST 060 107 8985



- cover plate 120 x 120 mm
- rosette 60 x 60 mm
- temperature control handle with safety limit stop at 38°C

	Brushed Champagne (22kt Gold)	ST 060 107 8985-46
	Dark Chrome	ST 060 107 8985-19
	Champagne (22kt Gold)	ST 060 107 8985-47

Individual components of this set

You need the following components for this set



1x 36 310 715-46



1x 36 416 985-46

SYMETRICS xTOOL Thermostat module with 1 valve - Brushed Champagne (22kt Gold)

CL.1

ST 060 107 8985

- rosette 60 x 60 mm





SYMETRICS xTOOL Thermostat module with 1 valve - Brushed Champagne (22kt Gold)

CL.1

ST 060 107 8985

SYMETRICS xTOOL Thermostat module with 1 valve - Brushed Champagne (22kt Gold)

CL.1

ST 060 107 8985
mm [inches]

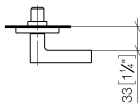
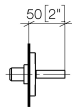
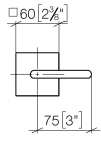

Flow rate chart

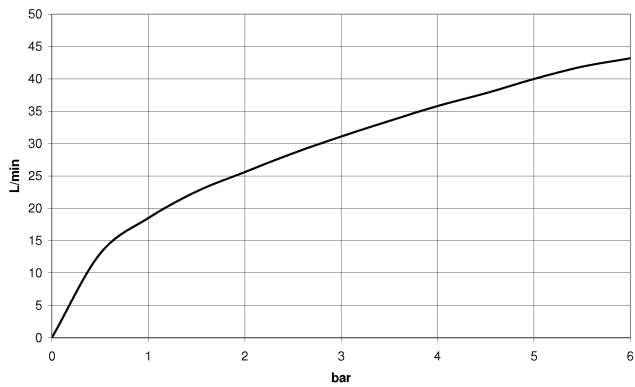



SYMETRICS xTOOL Thermostat module with 1 valve - Brushed Champagne (22kt Gold)

CL.1

ST 060 107 8985

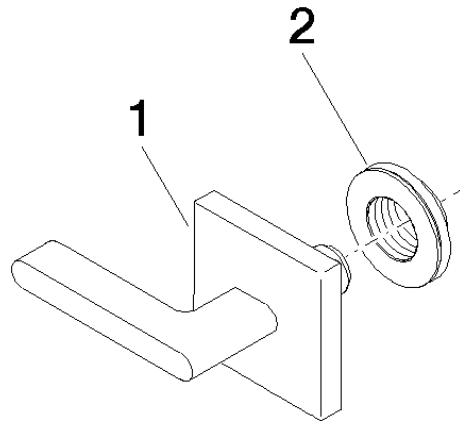

ST 060 107 8985

Spare parts list

Product version from 10/14/2020

Error: Subreport could not be shown.