



SYMETRICS xTOOL Thermostat module with 1 valve - Champagne (22kt Gold)

CL.1

ST 060 107 8985



- cover plate 120 x 120 mm
- rosette 60 x 60 mm
- temperature control handle with safety limit stop at 38°C

	Champagne (22kt Gold)	ST 060 107 8985-47
	Dark Chrome	ST 060 107 8985-19
	Brushed Champagne (22kt Gold)	ST 060 107 8985-46

Individual components of this set

You need the following components for this set



1x 36 416 985-47



1x 36 310 715-47

Error: Subreport could not be shown.

- rosette 60 x 60 mm



ST 060 107 8985

mm [inches]

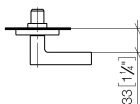
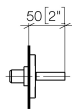
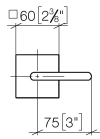

Flow rate chart

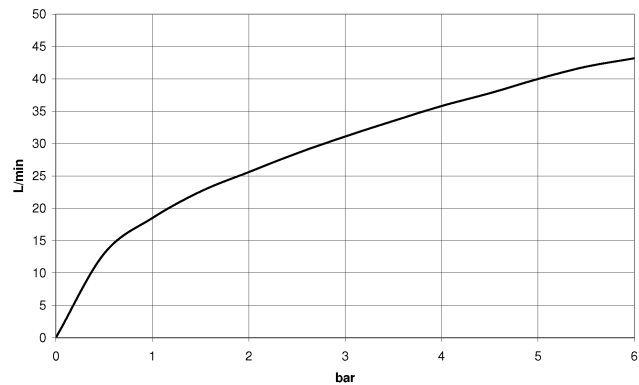

Product version from 10/14/2020

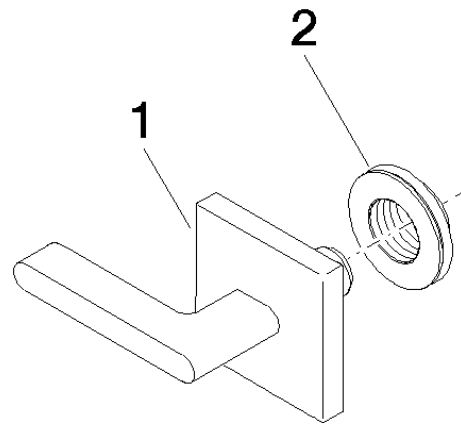

Spare parts list

Product version from 10/14/2020