

META xTOOL Thermostat module with 2 valves - Champagne (22kt Gold)

META

ST 060 115 5660



- cover plate Ø 123 mm
- rosette Ø 60 mm
- temperature control handle with safety limit stop at 38°C
- thermostat cartridge
- 2x head part with cut-to-length spindle and sleeve

	Champagne (22kt Gold)	ST 060 115 5660-47
	Chrome	ST 060 115 5660-00
	Brushed Platinum	ST 060 115 5660-06
	Dark Chrome	ST 060 115 5660-19
	Light Gold	ST 060 115 5660-26
	Brushed Light Gold	ST 060 115 5660-27
	Matte Black	ST 060 115 5660-33
	Brushed Bronze	ST 060 115 5660-42
	Brushed Champagne (22kt Gold)	ST 060 115 5660-46
	Brushed Chrome	ST 060 115 5660-93
	Brushed Dark Platinum	ST 060 115 5660-99

Individual components of this set

You need the following components for this set



1x 36 503 979-47



2x 36 607 661-47

ST 060 115 5660

Error: Subreport could not be shown.



- rosette Ø 60 mm
- head part with cut-to-length spindle and sleeve

	Champagne (22kt Gold)	36 607 661-4
	Chrome	36 607 661-0
	Brushed Platinum	36 607 661-0
	Dark Chrome	36 607 661-1
	Light Gold	36 607 661-2
	Brushed Light Gold	36 607 661-2
	Matte Black	36 607 661-3
	Brushed Bronze	36 607 661-4
	Brushed Champagne (22kt Gold)	36 607 661-4
	Brushed Chrome	36 607 661-9
	Brushed Dark Platinum	36 607 661-9

ST 060 115 5660

.7
—
10
—
16
—
9
—
16
—
17
—
13
—
2
—
6
—
13
—
19
—

Required miscellaneous



- Wall valve 1/2" -**
●max. recess depth 145 mm
●min. recess depth 85 mm

35 607 970 90

Required miscellaneous



- Wall valve 1/2" -**
●max. recess depth 145 mm
●min. recess depth 85 mm

35 607 970 90

ST 060 115 5660

mm [inches]

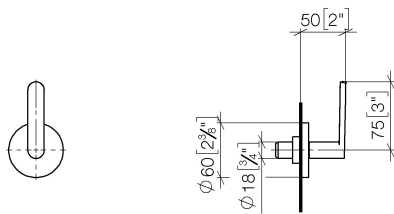

Certificates

IAPMO_4976 WRAS_2010 LGA_38 LGA_29 LGA_29

Codes & Standards

ASME A112.18.1	cUPC	DIN 4109	ISO 3822
Scottish Water Byelaws	UK Water Supply Regulations	Ü-Zeichen	

Product version from 7/1/2023

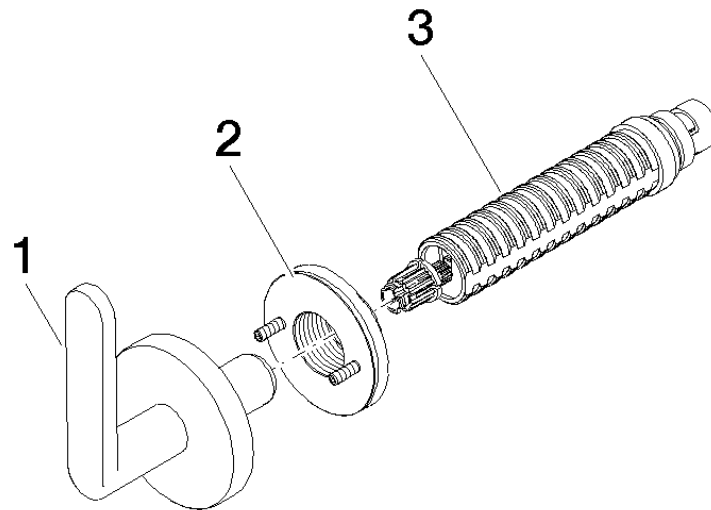



META xTOOL Thermostat module with 2 valves - Champagne (22kt Gold)

META

ST 060 115 5660

Spare parts list

Product version from 7/1/2023

No.	Item Number	Name	Quantity used	Delivery time
	90 20 66 014 04-47	handle	3	30