







MEM Bath spout without diverter for free-standing assembly - Brushed Durabron (23kt Gold)

MEM

13 672 780 Product version from 9/30/2005



- 280mm projection
- cascade
- total height 830 - 900 mm
- height up to aerator 665 – 735 mm
- push-on rosette 130 x 130 mm
- max. flow 47.8 l/min at 3 bar flow pressure
- WRAS

| | | |
|---|-------------------------------|---------------|
|  | Brushed Durabron (23kt Gold) | 13 672 780-28 |
|  | Chrome | 13 672 780-00 |
|  | Brushed Platinum | 13 672 780-06 |
|  | Platinum | 13 672 780-08 |
|  | Dark Chrome | 13 672 780-19 |
|  | Brushed Champagne (22kt Gold) | 13 672 780-46 |
|  | Champagne (22kt Gold) | 13 672 780-47 |

Required miscellaneous



- Concealed floor mounting -**
- max. recess depth 150 mm
 - min. recess depth 80 mm

35 945 970 90

MEM Bath spout without diverter for free-standing assembly - Brushed Durabron (23kt Gold)

MEM

13 672 780 Product version from 9/30/2005
mm [inches]



Flow rate chart

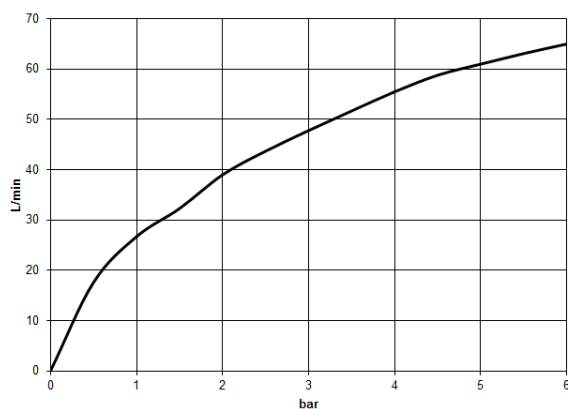

Codes & Standards

DIN 4109

ISO 3822

Scottish Water
Byelaws

UK Water Supply
Regulations

Ü-Zeichen



MEM Bath spout without diverter for free-standing assembly - Brushed
Durabrass (23kt Gold)

MEM

13 672 780 Product version from 9/30/2005

Certificates and sustainability

| | | |
|-----------|--------|-------------|
| WRAS_2005 | LGA_18 | WRAS_250602 |
|-----------|--------|-------------|

MEM Bath spout without diverter for free-standing assembly - Brushed Durabrass (23kt Gold)

MEM

13 672 780

Product version from 9/30/2005

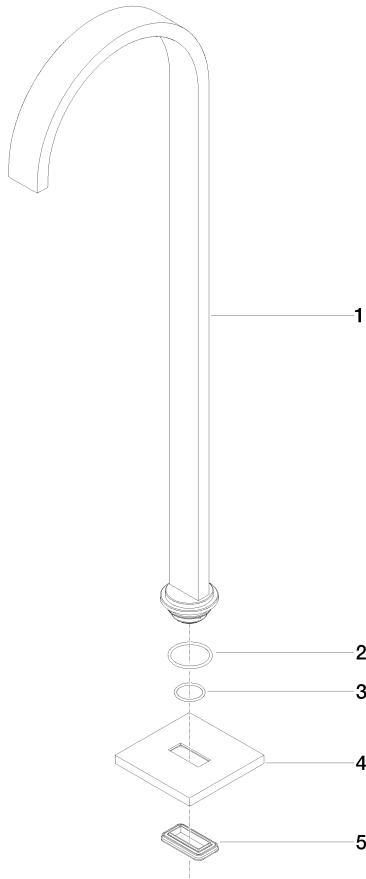

Spare parts list

| No. | Item Number | Name | Quantity used | Delivery time |
|-----|----------------------|---------|---------------|---------------|
| | 3 09 14 10 018 90 | seal | 1.00 | 2 |
| | 1 04 28 22 183 00-28 | spout | 1.00 | 20 |
| | 4 09 27 78 022-28 | rosette | 1.00 | 20 |
| | 5 09 14 03 106 90 | seal | 1.00 | 2 |
| | 2 09 14 10 084 90 | seal | 1.00 | 2 |