







MEM Bath spout without diverter for free-standing assembly - Brushed Champagne (22kt Gold)
MEM

13 672 780	Product version from 9/30/2005		
	<ul style="list-style-type: none"> • 280mm projection • cascade • total height 830 - 900 mm • height up to aerator 665 – 735 mm • push-on rosette 130 x 130 mm • max. flow 47.8 l/min at 3 bar flow pressure • WRAS 	<div>  <div> Brushed Champagne (22kt Gold) 13 672 780-46 </div> </div>	
		<div>  <div> Chrome 13 672 780-00 </div> </div>	
		<div>  <div> Brushed Platinum 13 672 780-06 </div> </div>	
		<div>  <div> Platinum 13 672 780-08 </div> </div>	
		<div>  <div> Dark Chrome 13 672 780-19 </div> </div>	
		<div>  <div> Brushed Durabrass (23kt Gold) 13 672 780-28 </div> </div>	
		<div>  <div> Champagne (22kt Gold) 13 672 780-47 </div> </div>	

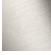
Required miscellaneous

<div>  <div> Concealed floor mounting - 35 945 970 90 </div> </div>	<ul style="list-style-type: none"> • max. recess depth 150 mm • min. recess depth 80 mm
-------------------------------------------------------------------------------------------------------------------------------------------------------------	-----------------------------------------------------------------------------------------------------------------

MEM Bath spout without diverter for free-standing assembly - Brushed Champagne (22kt Gold)

MEM

13 672 780 Product version from 9/30/2005
mm [inches]

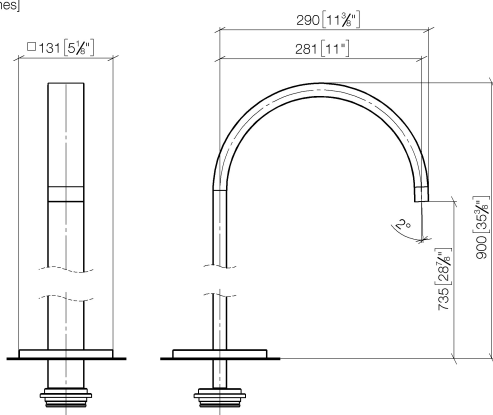

Flow rate chart

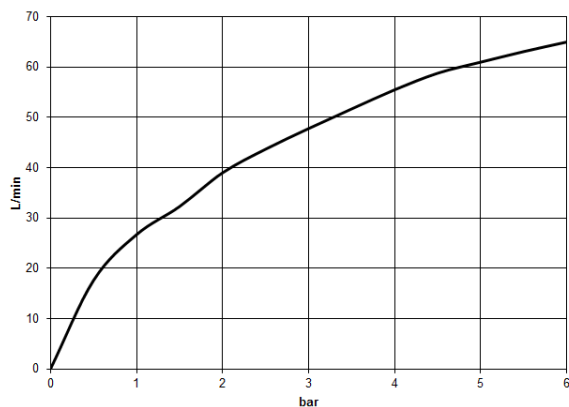

Codes & Standards

ASME A112.18.1	cUPC	DIN 4109	ISO 3822
----------------	------	----------	----------

Scottish Water
Byelaws

UK Water Supply
Regulations

Ü-Zeichen



MEM Bath spout without diverter for free-standing assembly - Brushed
Champagne (22kt Gold)

MEM

13 672 780 Product version from 9/30/2005

Certificates and sustainability

IAPMO_4976

LGA_18

WRAS_250602

MEM Bath spout without diverter for free-standing assembly - Brushed Champagne (22kt Gold)

MEM

13 672 780 Product version from 9/30/2005

