

33 818 875    Product version from 5/31/2010 to 7/25/2018



- 281mm projection
- pivotable spout 360°
- air-enriched flow
- height of mixer 422 mm
- height up to aerator 240 mm
- hole diameter 35 mm
- max. flow 8 l/min at 3 bar flow pressure
- lead-free
- This product can help a building meet the requirements of Green Building Rating Systems, e.g. LEED®, BREEAM®, DGNB
- WRAS

Recommended miscellaneous

|   |   |               |
|---|---|---------------|
| <hr/>   |   |               |
|  | <b>Dispenser without rosette - Chrome</b> | 82 424 970-00 |
|   |   |               |

Recommended miscellaneous

|   |  |               |
|---|--|---------------|
| <hr/>   |  |               |
|  | <b>Strainer waste with control handle - Chrome</b> | 10 712 970-00 |
|   |  |               |

33 818 875 Product version from 5/31/2010 to 7/25/2018

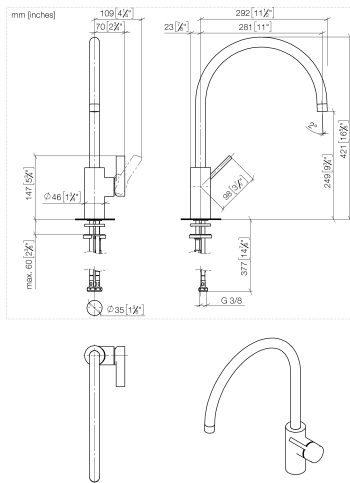

**Flow rate chart**

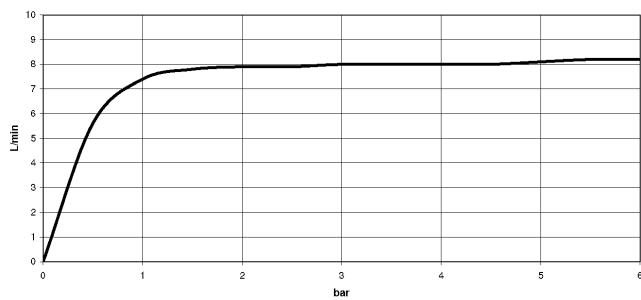

**Codes & Standards**

EN 817

Executive Order  
no. 1007

Scottish Water  
Byelaws

UK Water Supply  
Regulations

VA-Zeichen



TARA ULTRA Single-lever mixer - Chrome

TARA ULTRA

33 818 875    Product version from 5/31/2010 to 7/25/2018

Certificates and sustainability

GDV\_0400                      WRAS\_2101                      ETA\_18

33 818 875 Product version from 5/31/2010 to 7/25/2018

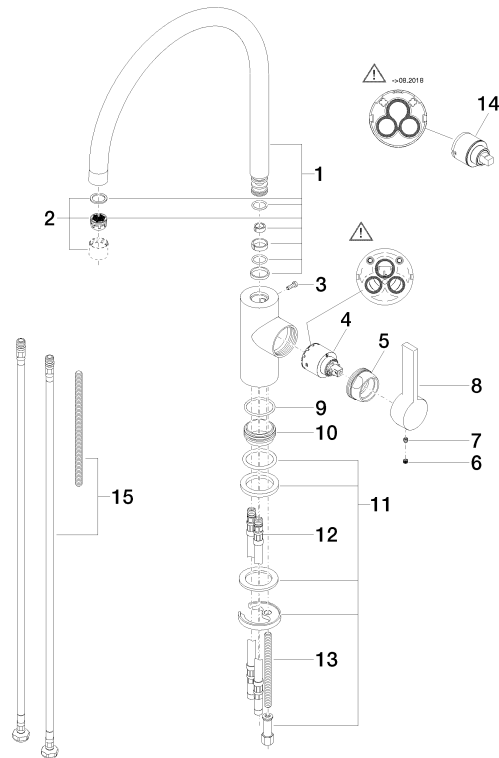

## Spare parts list

| No. | Item Number        | Name       | Quantity used | Delivery time |
|-----|--------------------|------------|---------------|---------------|
| 10  | 09 28 10 109-07    | ring       | 1.00          | 30            |
| 11  | 04 30 11 085 88 90 | fixing set | 1.00          | 2             |
| 12  | 04 30 04 016 00 90 | hose       | 2.00          | 60            |
| 8   | 09 20 79 040-00    | handle     | 1.00          | 10            |
| 3   | 09 30 30 080 90    | screw      | 1.00          | 2             |
| 5   | 09 24 04 107-00    | nut        | 1.00          | 10            |
| 2   | 90 23 01 004 07-00 | aerator    | 1.00          | 10            |
| 15  | 12 803 970 90      | extension  | 1.00          | 60            |
| 1   | 90 28 22 203 02-00 | spout      | 1.00          | 10            |
| 9   | 09 14 10 119 90    | seal       | 1.00          | 2             |
| 4   | 90 15 05 061 00 90 | cartridge  | 1.00          | 60            |
| 13  | 09 31 11 012 90    | pin        | 1.00          | 2             |
| 7   | 90 31 11 030 00 90 | pin        | 1.00          | 2             |
| 6   | 90 31 20 109 00 90 | plug       | 1.00          | 2             |
| 14  | 90 15 05 045 00 90 | cartridge  | 1.00          | 2             |