

35 620 970 90



- concealed rough parts
- Rain panel with 3 different flow modes
- AQUACIRCLE RAIN: Circular rain curtain, max. flow rate 12 l/min (at 3 bar)
- TEMPEST RAIN: Natural rain, max. flow rate 10 l/min (at 3 bar)
- Queen's Collar: rounded cascade, max. 24 l/min
- Ceiling installation enclosure 1356 x 1356 x 290 mm
- Opening diameter 1252 mm
- Ceiling construction with adequate structural strength for the permanent attachment of the device (weight: 57.5 kg / 127 lbs. (US)). M8 threaded bolts (minimum strength: 2000 N) are required to secure the ceiling module

## Input LED power supply

- Connector, 220-240V AC 50Hz power supply

## Output LED power supply

- 12V DC (CV)

## Output specification LED power supply

- SELV (Safety Extra Low Voltage)
- Provided by customer: Light switch

## Environment

- Not suitable for use in a steam room.
- Not suitable for outdoor use.
- Not suitable for use in chlorinated or salty environments.
- Comply with the protection zone regulations as defined in DIN VDE 0100, Part 701 (IEC 60364-7-701).

## Recommended miscellaneous

### Leak protection 3/4" -

12 012 970 90

- This article is needed 3x.



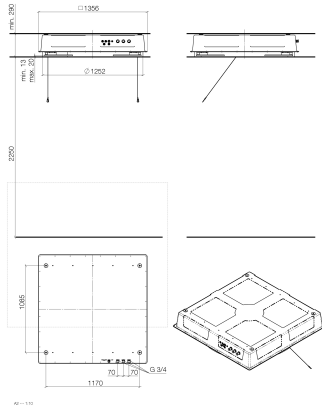

|          |          |           |
|----------|----------|-----------|
| DIN 4109 | ISO 3822 | Ü-Zeichen |
|----------|----------|-----------|

LGA\_29

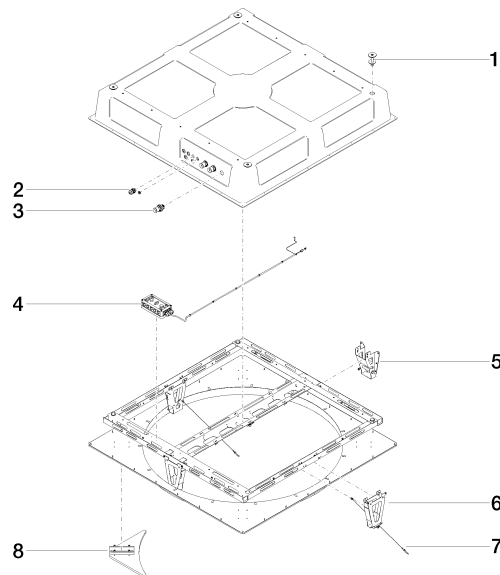

## Spare parts list

| No. | Item Number        | Name                   | Quantity used | Delivery time |
|-----|--------------------|------------------------|---------------|---------------|
| 6   | 90 17 20 209 00 90 | holder                 | 1.00          | 2             |
| 4   | 90 10 01 192 00 90 | electronic accessories | 1.00          | 2             |
| 1   | 04 24 03 239 02 90 | fixing set             | 4.00          | 2             |
| 3   | 90 24 03 285 00 90 | connection             | 3.00          | 2             |
| 5   | 90 17 20 205 00 90 | holder                 | 1.00          | 2             |
| 7   | 90 21 50 007 00 90 | accessories            | 2.00          | 2             |
| 8   | 90 17 20 215 00 90 | end stop               | 4.00          | 2             |
| 2   | 90 10 01 089 00 90 | accessories            | 1.00          | 2             |