







CL.1 Concealed three-way diverter - Brushed Champagne (22kt Gold)

CL.1

36 212 705

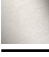
- rotary diverter
- rosette 60 x 60 mm
- WRAS 2307045



	Brushed Champagne (22kt Gold)	36 212 705-46
	Chrome	36 212 705-00
	Brushed Platinum	36 212 705-06
	Dark Chrome	36 212 705-19
	Champagne (22kt Gold)	36 212 705-47
	Brushed Dark Platinum	36 212 705-99

36 212 705

mm [inches]

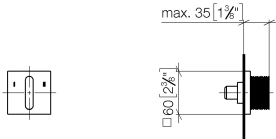

Flow rate chart

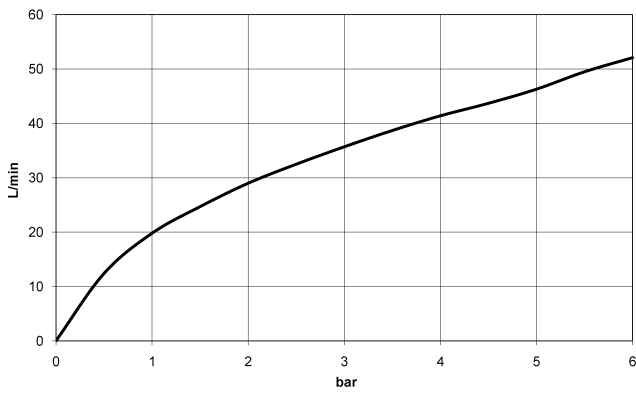

Codes & Standards

DIN 4109

ISO 3822

Scottish Water
Byelaws

UK Water Supply
Regulations

Ü-Zeichen



CL.1 Concealed three-way diverter - Brushed Champagne (22kt Gold)

CL.1

36 212 705

Certificates

WRAS_2307

LGA_38

36 212 705

Parts for other
finishes can be found
here: [Chrome](#)

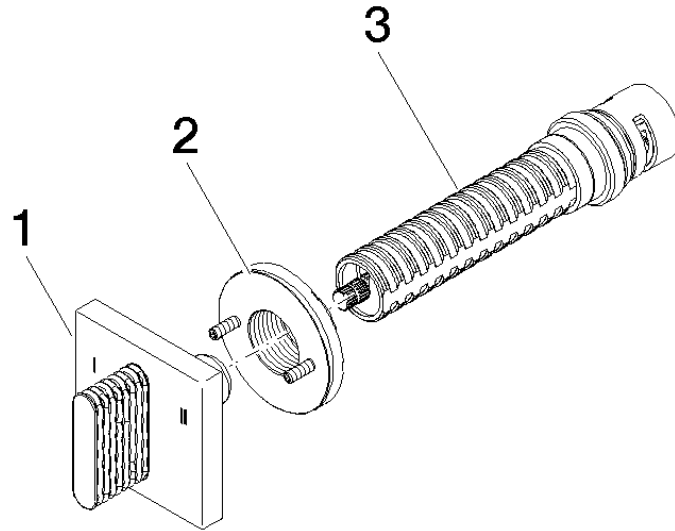



CL.1 Concealed three-way diverter - Brushed Champagne (22kt Gold)

CL.1

36 212 705

Spare parts list

No.	Item Number	Name	Quantity used	Delivery time
	90 20 70 053 10-46	handle	3	30