





CL.1 Wall valve clockwise closing cold 1/2" - Brushed Champagne (22kt Gold)

CL.1

36 627 706    Product version from 10/14/2020

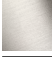

- with CASCADE structure
- rosette 60 x 60 mm
- with cold marking
- head part with cut-to-length spindle and sleeve
- WRAS

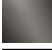
|   |                               |               |
|---|-------------------------------|---------------|
|  | Brushed Champagne (22kt Gold) | 36 627 706-46 |
|  | Chrome                        | 36 627 706-00 |
|  | Brushed Platinum              | 36 627 706-06 |
|  | Dark Chrome                   | 36 627 706-19 |
|  | Champagne (22kt Gold)         | 36 627 706-47 |
|  | Brushed Dark Platinum         | 36 627 706-99 |

Required miscellaneous

|   |  |               |
|---|--|---------------|
|  | <b>Wall valve 1/2" -</b><br>•max. recess depth 150 mm<br>•min. recess depth 105 mm | 35 607 970 90 |
|---|--|---------------|



CL.1 Wall valve clockwise closing cold 1/2" - Brushed Champagne (22kt Gold)

CL.1

36 627 706 Product version from 10/14/2020

mm [inches]



Codes & Standards

|                        |                             |           |          |
|------------------------|-----------------------------|-----------|----------|
| ASME A112.18.1         | cUPC                        | DIN 4109  | ISO 3822 |
| Scottish Water Byelaws | UK Water Supply Regulations | Ü-Zeichen |          |

Certificates and sustainability

|        |           |              |
|--------|-----------|--------------|
| LGA_29 | WRAS_2010 | IAPMO_4976 ( |
|--------|-----------|--------------|

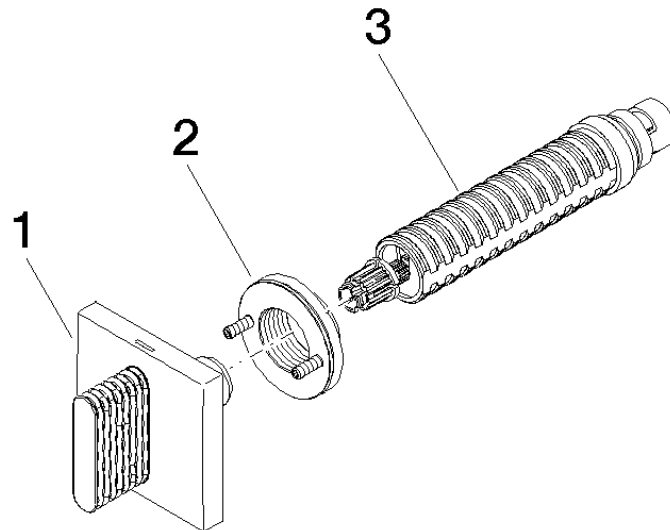

## Spare parts list

| No. | Item Number        | Name            | Quantity used | Delivery time |
|-----|--------------------|-----------------|---------------|---------------|
| 1   | 90 20 70 053 02-46 | handle ( cold ) | 1.00          | 30            |
| 3   | 90 90 03 143 00 90 | top             | 1.00          | 2             |
| 2   | 90 21 02 108 00 90 | disc            | 1.00          | 2             |