









10 713 809 Produktversion ab 01.07.2023

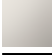

- zur Betätigung eines Müllzerkleinerers
- Kompatibel mit Müllzerkleinerern mit eingebautem Druckluftschalter des Herstellers Insinkerator®, z.B. Evolution.
- Artikel nicht in allen Märkten verfügbar. Bitte kontaktieren Sie den Dornbracht Außendienst.
- Mehr Informationen unter www.insinkerator.com

	Bronze gebürstet	10 713 809-42
	Chrom	10 713 809-00
	Platin gebürstet	10 713 809-06
	Platin	10 713 809-08
	Messing (23kt Gold)	10 713 809-09
	Dark Chrome	10 713 809-19
	Messing gebürstet (23kt Gold)	10 713 809-28
	Schwarz matt	10 713 809-33
	Champagne gebürstet (22kt Gold)	10 713 809-46
	Champagne (22kt Gold)	10 713 809-47
	Chrom gebürstet (Edelstahl-Look)	10 713 809-93
	Dark Platinum gebürstet	10 713 809-99

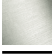
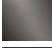
mm [inches]

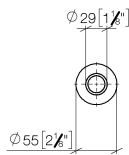
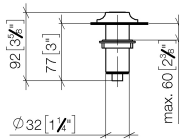

Ersatzteile für die
anderen
Oberflächenvarianten
finden Sie hier:
Chrom

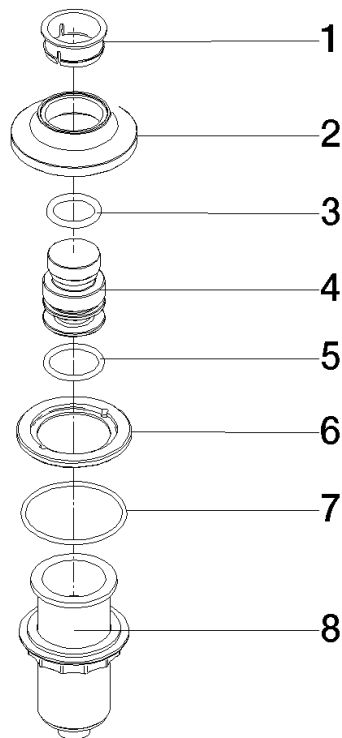

Ersatzteilstückliste

Nr.	Artikelnummer	Benennung	Verbaumenge	Lieferzeit
7	09 14 10 210 90	Dichtung	1,00	2
1	09 28 10 141 90	Huelse	1,00	2
5	09 14 10 015 90	Dichtung	1,00	2
4	90 21 33 052 00-42	Druckknopf	1,00	30
2	90 27 80 034 00-42	Rosette	1,00	30
6	90 24 01 033 00 90	Ring	1,00	2
8	04 30 01 186 00 90	Huelse	1,00	2
3	09 14 10 507 90	Dichtung	1,00	2