









VAIA Wannenauslauf für Wandmontage - Dark Platinum gebürstet

VAIA

13 801 809

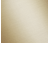

- Ausladung 200 mm
- runder Normalstrahl
- Bohrungsdurchmesser 37 mm
- Rosette Ø 60 mm
- Anschluss 1/2"
- Durchfluss max. 21,5 l/min bei 3 bar Fließdruck

| | | |
|--|---------------------------------|---------------|
|  | Dark Platinum gebürstet | 13 801 809-99 |
|  | Chrom | 13 801 809-00 |
|  | Platin gebürstet | 13 801 809-06 |
|  | Platin | 13 801 809-08 |
|  | Dark Chrome | 13 801 809-19 |
|  | Messing gebürstet (23kt Gold) | 13 801 809-28 |
|  | Bronze gebürstet | 13 801 809-42 |
|  | Champagne gebürstet (22kt Gold) | 13 801 809-46 |
|  | Champagne (22kt Gold) | 13 801 809-47 |

Empfohlenes Zubehör



- UP-Wandwinkel -**
 •Max. Einbautiefe 163 mm
 •Min. Einbautiefe 90 mm

35 085 970 90

13 801 809

mm [inches]

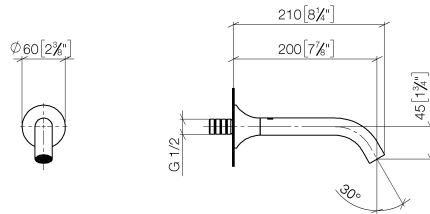

Durchflussdiagramm

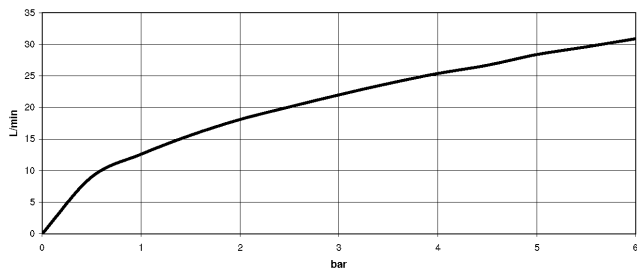

Codes & Standards

DIN 4109

ISO 3822

Scottish Water
Byelaws

UK Water Supply
Regulations

Ü-Zeichen



VAIA Wannenauslauf für Wandmontage - Dark Platinum gebürstet

VAIA

13 801 809

Zertifikate

WRAS_2306

LGA_29

Produktversion ab 3/13/2017

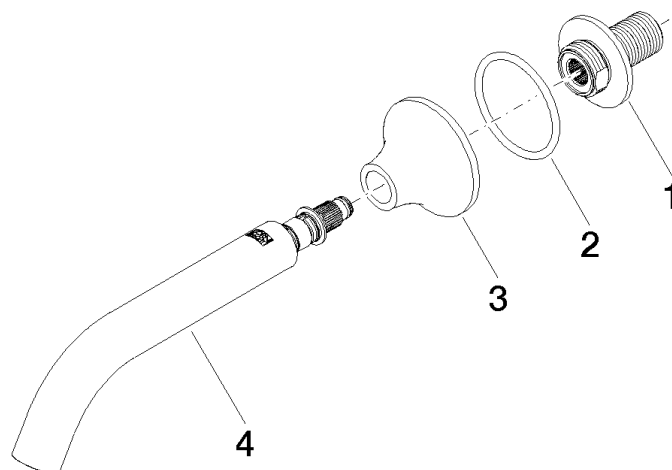



VAIA Wannenauslauf für Wandmontage - Dark Platinum gebürstet

VAIA

13 801 809

Ersatzteilstückliste

Produktversion ab 3/13/2017

| Nr. | Artikelnummer | Benennung | Verbaumenge | Lieferzeit |
|-----|-----------------|-----------|-------------|------------|
| | 09 24 03 269 90 | Nippel | 4 | 2 |