







MADISON Wandanschlussbogen - Dark Platinum gebürstet

MADISON

28 450 370    Produktversion bis 06.07.2018



- Brauseabgang 1/2"
  - Rosette Ø 60 mm
  - Anschluss 1/2"
- Eigensicher gegen Rückfließen.

|   |                               |                    |
|---|-------------------------------|--------------------|
|    | Dark Platinum gebürstet       | 28 450 370-99      |
|    | Chrom                         | 28 450 370-00      |
|   | Chrom                         | 28 450 370-00 0010 |
|    | Platin gebürstet              | 28 450 370-06      |
|   | Platin gebürstet              | 28 450 370-06 0010 |
|    | Platin                        | 28 450 370-08      |
|   | Platin                        | 28 450 370-08 0010 |
|    | Messing (23kt Gold)           | 28 450 370-09      |
|   | Messing (23kt Gold)           | 28 450 370-09 0010 |
|    | Messing gebürstet (23kt Gold) | 28 450 370-28      |
|   | Messing gebürstet (23kt Gold) | 28 450 370-28 0010 |
|  | Dark Brass gebürstet          | 28 450 370-39      |
|   | Dark Platinum gebürstet       | 28 450 370-99 0010 |

Empfohlenes Zubehör



- UP-Wandwinkel -**

35 085 970 90

  - Min. Einbautiefe 90 mm
  - Max. Einbautiefe 163 mm

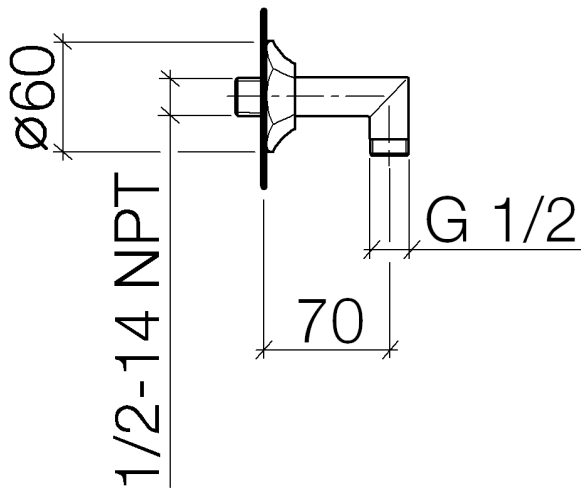

#### Durchflussdiagramm

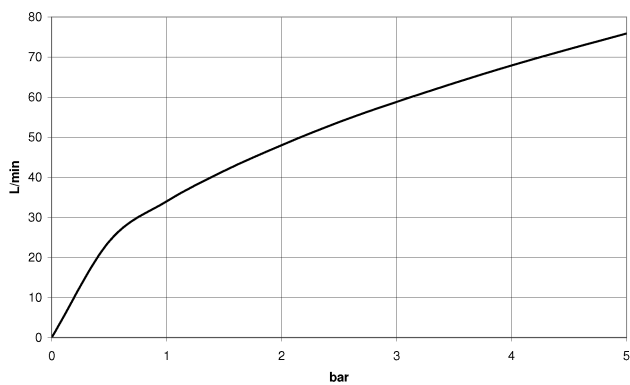

#### Codes & Standards

EN 1717

Scottish Water  
Byelaws

UK Water Supply  
Regulations



## MADISON Wandanschlussbogen - Dark Platinum gebürstet

---

MADISON

28 450 370 Produktversion bis 06.07.2018

Zertifikate und Nachhaltigkeit

---

Belgaqua\_21-381-2 WRAS\_240502

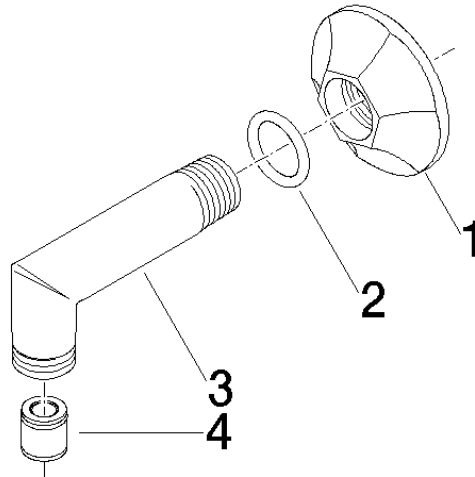

## Ersatzteilstückliste

| Nr. | Artikelnummer      | Benennung             | Verbaumenge | Lieferzeit |
|-----|--------------------|-----------------------|-------------|------------|
| 3   | 09 11 03 021-99    | Anschluss             | 1,00        | 20         |
| 1   | 09 27 37 003-99    | Rosette               | 1,00        | 20         |
| 4   | 90 23 01 040 00 90 | Rueckflussverhinderer | 1,00        | 2          |
| 2   | 90 14 10 026 00 90 | Dichtung              | 1,00        | 2          |