







MADISON Wandanschlussbogen - Chrom

MADISON

28 450 410 Produktversion bis 06.07.2018

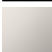

- Brauseabgang 1/2"
 - Rosette Ø 55 mm
 - Anschluss 1/2"
- Eigensicher gegen Rückfließen.

	Chrom	28 450 410-00
	Platin gebürstet	28 450 410-06
	Platin	28 450 410-08
	Messing (23kt Gold)	28 450 410-09
	Messing gebürstet (23kt Gold)	28 450 410-28
	Dark Platinum gebürstet	28 450 410-99

Empfohlenes Zubehör

- 

UP-Wandwinkel -
 •Min. Einbautiefe 90 mm
 •Max. Einbautiefe 163 mm

35 085 970 90

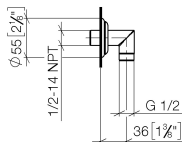

Durchflussdiagramm

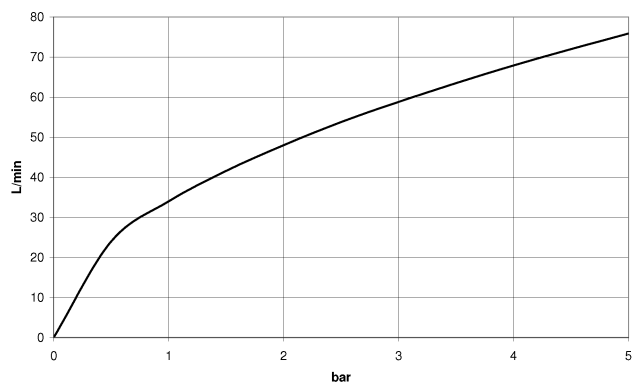

Codes & Standards

EN 1717

Scottish Water
Byelaws

UK Water Supply
Regulations



MADISON Wandanschlussbogen - Chrom

MADISON

28 450 410 Produktversion bis 06.07.2018

Zertifikate und Nachhaltigkeit

Belgaqua_21-381-2 WRAS_240502

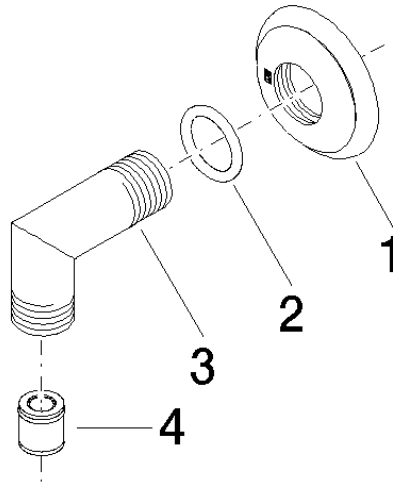

Ersatzteilstückliste

Nr.	Artikelnummer	Benennung	Verbaumenge	Lieferzeit
1	09 27 35 003-00	Rosette	1,00	10
3	09 11 03 121-00	Anschluss	1,00	10
4	90 23 01 141 00 90	Rueckflussverhinderer	1,00	2
2	90 14 10 026 00 90	Dichtung	1,00	2