









22 901 979 Produktversion bis 27.05.2021



- Rosette Ø 55 mm
- Schlauchabdeckung 200 mm, ablängbar

| | | |
|---|---------------------------------|---------------|
|  | Messing (23kt Gold) | 22 901 979-09 |
|  | Chrom | 22 901 979-00 |
|  | Platin gebürstet | 22 901 979-06 |
|  | Platin | 22 901 979-08 |
|  | Dark Chrome | 22 901 979-19 |
|  | Messing gebürstet (23kt Gold) | 22 901 979-28 |
|  | Schwarz matt | 22 901 979-33 |
|  | Champagne gebürstet (22kt Gold) | 22 901 979-46 |
|  | Champagne (22kt Gold) | 22 901 979-47 |
|  | Chrom gebürstet | 22 901 979-93 |
|  | Dark Platinum gebürstet | 22 901 979-99 |

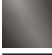
mm [inches]



Durchflussdiagramm



Codes & Standards

Scottish Water
Byelaws

UK Water Supply
Regulations



Eckventil - Messing (23kt Gold)

SERIENSPEZIFISC

22 901 979 Produktversion bis 27.05.2021

Zertifikate und Nachhaltigkeit

WRAS_2205

Ersatzteile für die
anderen
Oberflächenvarianten
finden Sie hier:
Chrom

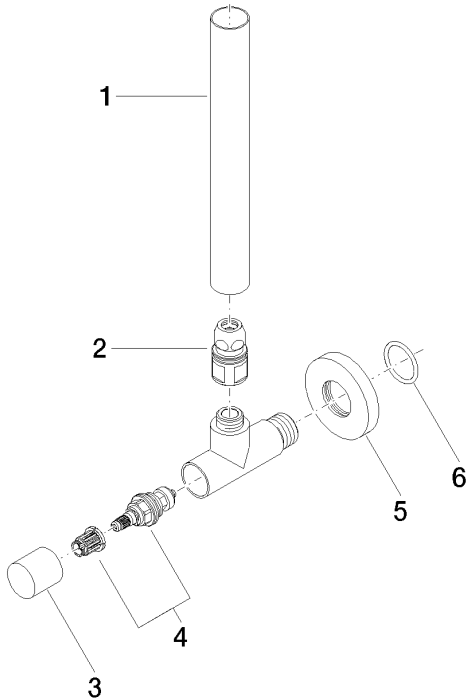

Ersatzteilstückliste

| Nr. | Artikelnummer | Benennung | Verbaumenge | Lieferzeit |
|-----|--------------------|-------------|-------------|------------|
| 3 | 09 20 22 001-09 | Griff | 1,00 | 40 |
| 5 | 09 27 22 015-09 | Rosette | 1,00 | 40 |
| 1 | 09 28 22 020-09 | Rohr | 1,00 | 40 |
| 2 | 90 24 03 276 00 90 | Umruestsatz | 1,00 | 2 |
| 4 | 90 90 03 006 00 90 | Oberteil | 1,00 | 2 |
| 6 | 09 14 10 093 90 | Dichtung | 1,00 | 2 |