



26 413 625



Passt zu: TARA, META

- Wandrohr mit Schieber
- Rohrdurchmesser 18 mm
- Rosette Ø 55 mm
- Stichmaß 800 mm
- Metallbrauseschlauch 1750 mm mit integriertem Verdreherschutz
- Brauseschlauchanschluss 3/8"

Dieser Artikel enthält keine Handbrause!

	Chrom	26 413 625-00
	Platin gebürstet	26 413 625-06
	Platin	26 413 625-08
	Dark Chrome	26 413 625-19
	Light Gold	26 413 625-26
	Light Gold gebürstet	26 413 625-27
	Messing gebürstet (23kt Gold)	26 413 625-28
	Schwarz matt	26 413 625-33
	Bronze gebürstet	26 413 625-42
	Champagne gebürstet (22kt Gold)	26 413 625-46
	Champagne (22kt Gold)	26 413 625-47
	Chrom gebürstet	26 413 625-93
	Dark Platin gebürstet	26 413 625-99

Empfohlenes Zubehör

	UP-Wandwinkel - •Max. Einbautiefe 163 mm •Min. Einbautiefe 90 mm	35 085 970 90
---	---	---------------

Empfohlenes Zubehör

	Wandanschlussbogen - Chrom	28 450 625-00
---	-----------------------------------	---------------

Benötigtes Zubehör

	Handbrause - Chrom	28 016 979-00
---	---------------------------	---------------

Benötigtes Zubehör

	Handbrause - Chrom	28 012 979-00
---	---------------------------	---------------

Benötigtes Zubehör

	Handbrause FlowReduce - Chrom	28 016 979-00 0010
---	--------------------------------------	-----------------------

Benötigtes Zubehör

	Handbrause - Chrom	28 017 979-00
---	---------------------------	---------------

Benötigtes Zubehör

	Handbrause FlowReduce - Chrom	28 012 979-00 0010
---	--------------------------------------	-----------------------

Benötigtes Zubehör

	Handbrause - Chrom	28 018 979-00
---	---------------------------	---------------

Benötigtes Zubehör

	Handbrause FlowReduce - Chrom	28 018 979-00 0010
---	--------------------------------------	-----------------------

26 413 625

mm [inches]

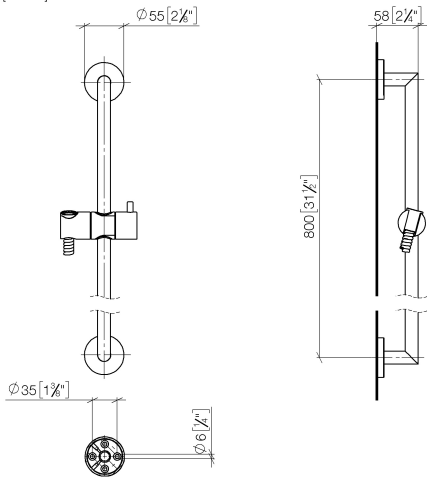

Zertifikate

WRAS_2009048. ACS_20 ACC LY 738. IAPMO_4976 (4).

26 413 625

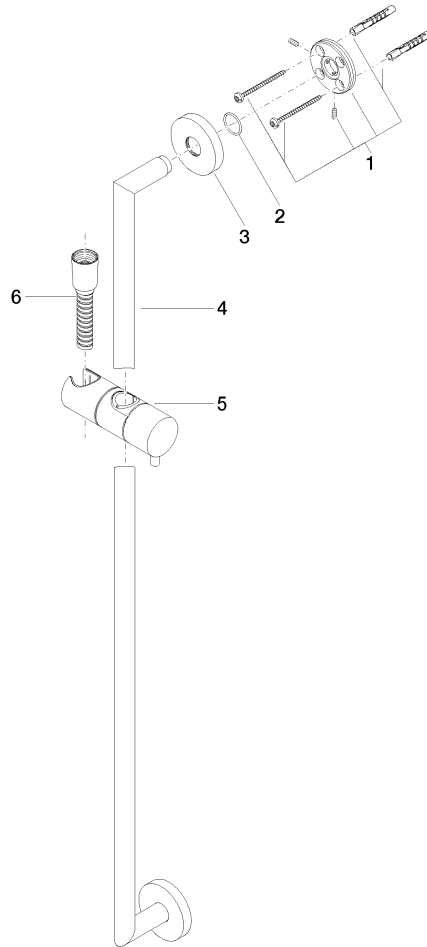

Ersatzteilstückliste

Nr.	Artikelnummer	Benennung	Verbaumenge	Lieferzeit
1	05 17 62 500 00 90	Befestigungssatz	2	2
2	90 14 10 032 00 90	Dichtung	2	2
3	08 27 62 500-00	Rosette	2	10
4	05 28 22 590 01-00	Stange	1	10
5	12 580 970-00	Schieber - Chrom	1	10
6	28 322 970-00	Metall-Brauseschlauch 1/2" x 3/8" x 1750 mm - Chrom	1	2