









VAIA Wandanschlussbogen - Champagne gebürstet (22kt Gold)

VAIA

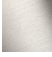
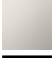
28 450 809 Produktversion ab 06.07.2018



- Brauseabgang 3/8"
 - Rosette Ø 60 mm
 - Anschluss 1/2"
- Eigensicher gegen Rückfließen.

	Champagne gebürstet (22kt Gold)	28 450 809-46
	Chrom	28 450 809-00
	Platin gebürstet	28 450 809-06
	Platin	28 450 809-08
	Dark Chrome	28 450 809-19
	Messing gebürstet (23kt Gold)	28 450 809-28
	Bronze gebürstet	28 450 809-42
	Champagne (22kt Gold)	28 450 809-47
	Dark Platinum gebürstet	28 450 809-99

Empfohlenes Zubehör



- UP-Wandwinkel -**
 •Min. Einbautiefe 90 mm
 •Max. Einbautiefe 163 mm

35 085 970 90

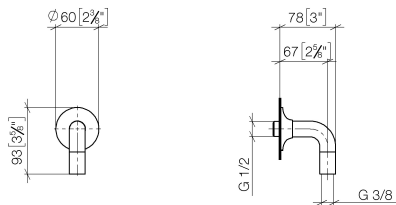

Durchflussdiagramm



Codes & Standards

ASME A112.18.1

cUPC

EN 1717

Scottish Water
Byelaws

UK Water Supply
Regulations



VAIA Wandanschlussbogen - Champagne gebürstet (22kt Gold)

VAIA

28 450 809 Produktversion ab 06.07.2018

Zertifikate und Nachhaltigkeit

Belgaqua_22_280_2 IAPMO_4976

WRAS_240702

