

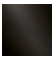







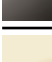

28 505 979

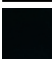

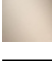
- Ausladung 155 mm
- Kugelgelenk 18° schwenkbar (in jede Richtung)
- Dreifach bzw. fünffach verstellbar: PURIFY RAIN, COMPACT SOFT FLOW, COMPACT AQUAPRESSURE FLOW, Durchfluss max. 7,6 l/min (bei 3 Bar)
- mit Antikalk-System
- Brausekopf Ø 100 mm
- Rosette Ø 60 mm
- Anschluss 1/2"
- Funktion ab: 5,5 l/min

Passt zu: TARA, LISSÉ, VAIA, META

	Dark Platinum gebürstet	28 505 979-99
	Chrom	28 505 979-00
	Platin gebürstet	28 505 979-06
	Platin	28 505 979-08
	Dark Chrome	28 505 979-19
	Light Gold	28 505 979-26
	Light Gold gebürstet	28 505 979-27
	Messing gebürstet (23kt Gold)	28 505 979-28
	Schwarz matt	28 505 979-33
	Bronze gebürstet	28 505 979-42
	Champagne gebürstet (22kt Gold)	28 505 979-46
	Champagne (22kt Gold)	28 505 979-47
	Chrom gebürstet	28 505 979-93

Empfohlenes Zubehör

**UP-Wandwinkel - 35 085 970 90**



- Max. Einbautiefe 163 mm
- Min. Einbautiefe 90 mm

28 505 979

mm [inches]

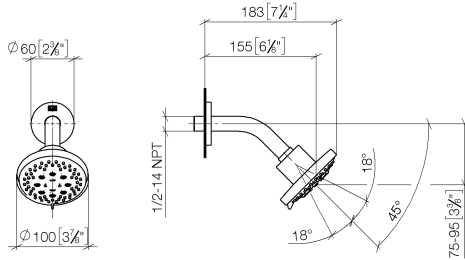

**Durchflussdiagramm**

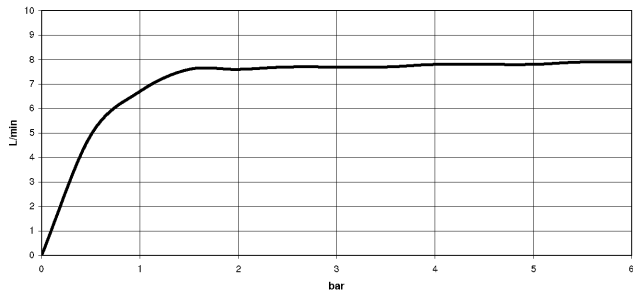

**Zertifikate**

LGA\_28661.

WRAS\_2201056.

28 505 979

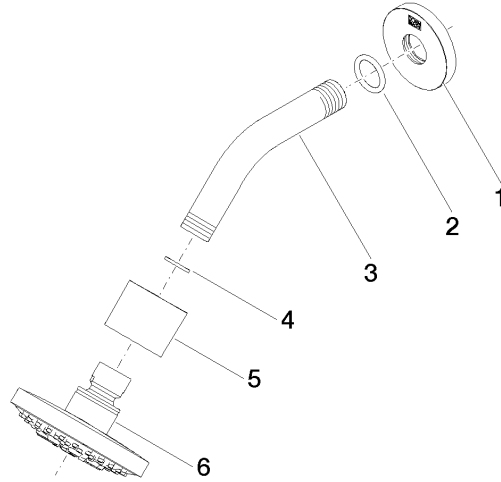

### Ersatzteilstückliste

Nr.	Artikelnummer	Benennung	Verbaumenge	Lieferzeit
1	09 27 22 045-99	Rosette	1	30
2	90 14 10 026 00 90	Dichtung	1	2
3	09 11 03 011-99	Anschluss	1	30
4	90 14 20 002 00 90	Dichtung	1	2
5	09 11 01 191-99	Abdeckung	1	30
6	90 12 05 055 00-99	Brause	1	30