

Badetuchhalter - Chrom gebürstet









SERIENSPEZIFISC

83 080 979 Produktversion ab 01.07.2023



- Stichmaß 800 mm
- Breite 840 mm
- Höhe 40 mm
- Rosette Ø 40 mm
- Ausladung 65 mm

Passt zu ELIO, ENO, MEM, META SQUARE, SYNC und TARA ULTRA

| | | |
|---|---------------------------------------|---------------|
|  | Chrom gebürstet | 83 080 979-93 |
|  | Chrom | 83 080 979-00 |
|  | Platin gebürstet | 83 080 979-06 |
|  | Dark Chrome | 83 080 979-19 |
|  | Messing gebürstet (23kt Gold) | 83 080 979-28 |
|  | Schwarz matt | 83 080 979-33 |
|  | Champagne gebürstet (22kt Gold) | 83 080 979-46 |
|  | Champagne (22kt Gold) | 83 080 979-47 |
|  | Dark Platinum gebürstet | 83 080 979-99 |

83 080 979 Produktversion ab 01.07.2023

mm [inches]

M 1:10



Ersatzteile für die
anderen
Oberflächenvarianten
finden Sie hier:
Chrom

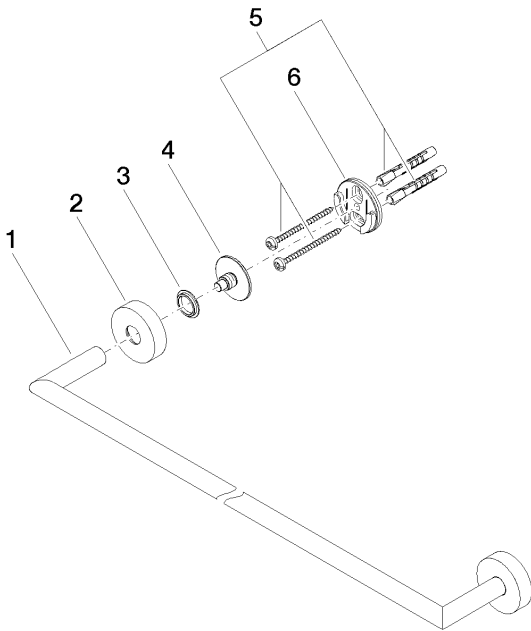

Ersatzteilstückliste

| Nr. | Artikelnummer | Benennung | Verbaumenge | Lieferzeit |
|-----|--------------------|------------------|-------------|------------|
| 1 | 05 28 22 623 00-93 | Halter | 1,00 | 20 |
| 6 | 08 17 97 501 07 | Halter | 2,00 | 2 |
| 4 | 08 17 97 560 90 | Halter | 2,00 | 2 |
| 5 | 05 30 31 025 00 90 | Befestigungssatz | 2,00 | 2 |
| 3 | 08 30 11 516 90 | Ring | 2,00 | 2 |
| 2 | 08 27 97 500-93 | Rosette | 2,00 | 20 |