

## TARA Three-hole basin mixer with pop-up waste - Brushed Chrome







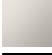

TARA

20 713 882 Product version from 6/30/2009 to 6/25/2021



- 165mm projection
- pivotable spout 360°
- circular, air-enriched flow
- height of mixer 285 mm
- height up to aerator 163 mm
- hole diameter valve 32 mm
- hole diameter spout 35 mm
- rosette Ø 55 mm
- 2x screw-in M 10 x 1 pressure hose, leak-tested
- max. flow 7 l/min
- lead-free
- WRAS
- This product can help a building meet the requirements of Green Building Rating Systems, e.g. LEED®, BREEAM®, DGNB

Only suitable for basins with an overflow.

|   |                               |               |
|---|-------------------------------|---------------|
|    | Brushed Chrome                | 20 713 882-93 |
|    | Chrome                        | 20 713 882-00 |
|    | Brushed Platinum              | 20 713 882-06 |
|    | Platinum                      | 20 713 882-08 |
|    | Dark Chrome                   | 20 713 882-19 |
|    | Brushed Durabrass (23kt Gold) | 20 713 882-28 |
|    | Matte Black                   | 20 713 882-33 |
|    | Brushed Dark Brass            | 20 713 882-39 |
|    | Brushed Bronze                | 20 713 882-42 |
|   | Brushed Champagne (22kt Gold) | 20 713 882-46 |
|  | Champagne (22kt Gold)         | 20 713 882-47 |
|  | Brushed Dark Platinum         | 20 713 882-99 |

## TARA Three-hole basin mixer with pop-up waste - Brushed Chrome

TARA

20 713 882 Product version from 6/30/2009 to 6/25/2021

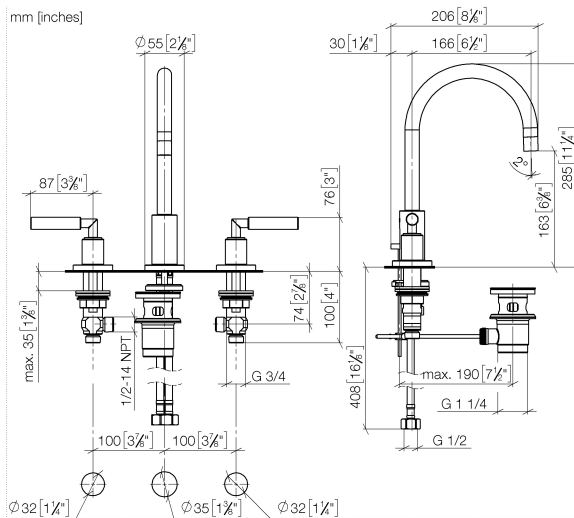

### Flow rate chart

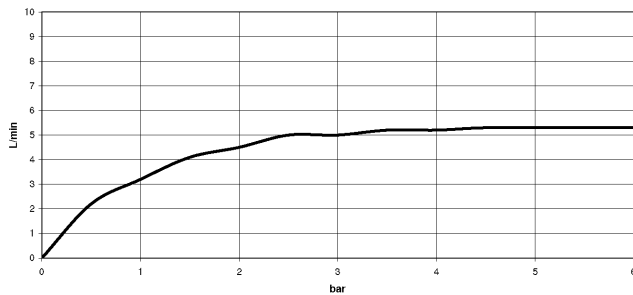

### Codes & Standards

|                           |                                |                             |            |
|---------------------------|--------------------------------|-----------------------------|------------|
| DIN 4109                  | EN 200                         | Executive Order<br>no. 1007 | ISO 3822   |
| Scottish Water<br>Byelaws | UK Water Supply<br>Regulations | Ü-Zeichen                   | VA-Zeichen |
| XP P 41-280               |                                |                             |            |



TARA Three-hole basin mixer with pop-up waste - Brushed Chrome

TARA

20 713 882    Product version from 6/30/2009 to 6/25/2021

Certificates and sustainability

|        |        |           |               |          |
|--------|--------|-----------|---------------|----------|
| LGA_18 | ETA_18 | WRAS_2212 | ACS_20 ACC LY | GDV_0400 |
|--------|--------|-----------|---------------|----------|

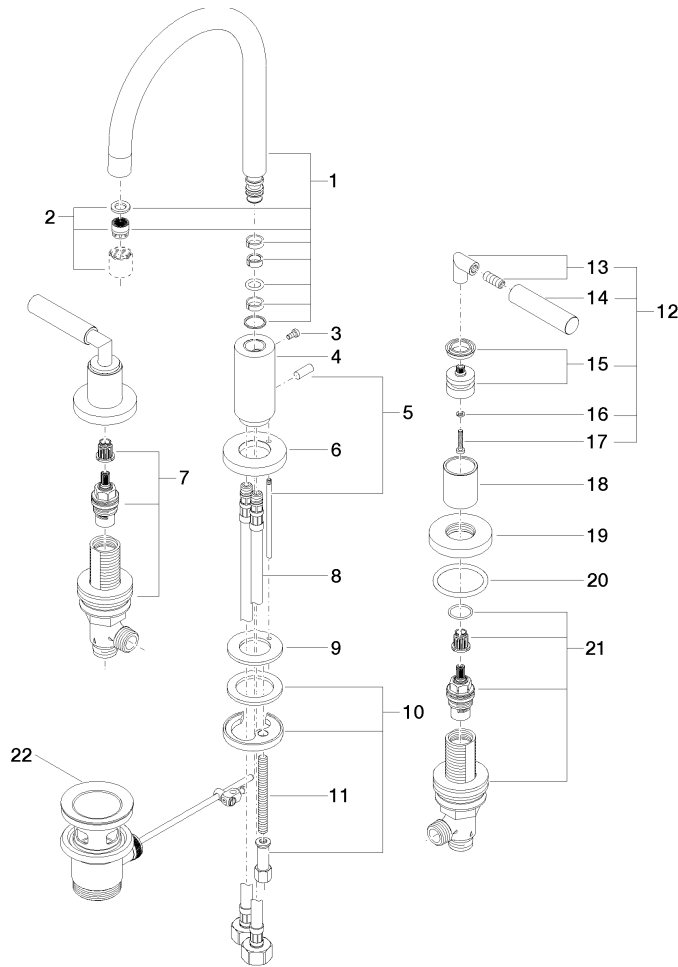





## TARA Three-hole basin mixer with pop-up waste - Brushed Chrome

TARA

20 713 882 Product version from 6/30/2009 to 6/25/2021

### Spare parts list

| No.  | Item Number        | Name         | Quantity used | Delivery time |
|--|--------------------|--------------|---------------|---------------|
| 13   | 04 18 20 022 00-93 | angle        | 2.00          | -             |
| Spare part can no longer be ordered, please order the replacement item |                    |              |               |               |
| 2  | 90 23 01 028 03-93 | aerator      | 1.00          | 20            |
| 12   | 04 20 88 052 00-93 | handle       | 2.00          | 20            |
| 4  | 09 11 10 087 10-93 | connection   | 1.00          | 20            |
| 9  | 09 14 05 047 90    | seal         | 1.00          | 2             |
| 21   | 90 17 11 040 50 90 | side panel   | 1.00          | 2             |
| 18   | 09 21 02 140-93    | sleeve       | 2.00          | 20            |
| 3  | 09 30 30 057 90    | screw        | 1.00          | 2             |
| 10   | 04 30 11 038 00 90 | fixing set   | 1.00          | 2             |
| 14   | 09 20 88 052-93    | handle       | 2.00          | 20            |
| 7  | 90 17 11 040 51 90 | side panel   | 1.00          | 2             |
| 15   | 90 12 12 007 00-93 | base         | 2.00          | 20            |
| 19   | 09 27 89 105-93    | rosette      | 2.00          | 20            |
| 8  | 04 30 04 019 00 90 | hose         | 2.00          | 2             |
| 5  | 04 20 89 030 80-93 | pull-rod     | 1.00          | 20            |
| 1  | 90 28 22 213 01-93 | spout        | 1.00          | 20            |
| 6  | 09 28 10 133-93    | ring         | 1.00          | 20            |
| 11   | 09 31 11 011 90    | pin          | 1.00          | 2             |
| 16   | 90 30 11 029 00 90 | disc         | 2.00          | 2             |
| 22   | 90 11 01 001 00-93 | pop-up waste | 1.00          | 20            |
| 17   | 90 30 30 075 00 90 | screw        | 2.00          | 2             |
| 20   | 90 14 10 043 00 90 | seal         | 2.00          | 2             |