

## MADISON Hand shower - Brushed Dark Platinum

MADISON

28 002 978 Product version from 7/1/2025



- Three settings: COMPACT RAIN, COMPACT SOFT FLOW, COMPACT AQUAPRESSURE FLOW, max. flow rate 9 l/min (at 3 bar)
- with anti-scale system
- spray head Ø 95mm
- 1/2" connection

Intrinsic protection against back flow.

|   |                               |                    |
|---|-------------------------------|--------------------|
|    | Brushed Dark Platinum         | 28 002 978-99      |
|    | Chrome                        | 28 002 978-00      |
|    | Chrome                        | 28 002 978-00 0010 |
|    | Brushed Platinum              | 28 002 978-06      |
|    | Brushed Platinum              | 28 002 978-06 0010 |
|    | Platinum                      | 28 002 978-08      |
|    | Platinum                      | 28 002 978-08 0010 |
|    | Durabrand (23kt Gold)         | 28 002 978-09      |
|    | Durabrand (23kt Gold)         | 28 002 978-09 0010 |
|  | Brushed Durabrand (23kt Gold) | 28 002 978-28      |
|  | Brushed Durabrand (23kt Gold) | 28 002 978-28 0010 |
|  | Brushed Dark Brass            | 28 002 978-39      |
|  | Brushed Dark Brass            | 28 002 978-39 0010 |
|  | Brushed Chrome                | 28 002 978-93      |
|  | Brushed Chrome                | 28 002 978-93 0010 |
|  | Brushed Dark Platinum         | 28 002 978-99 0010 |

mm [inches]

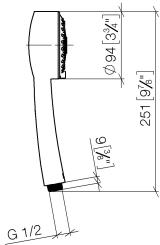

Flow rate chart



Codes & Standards

|          |          |           |
|----------|----------|-----------|
| DIN 4109 | ISO 3822 | Ü-Zeichen |
|----------|----------|-----------|



## MADISON Hand shower - Brushed Dark Platinum

---

MADISON

28 002 978 Product version from 7/1/2025

Certificates and sustainability

---

LGA\_18

28 002 978 Product version from 7/1/2025

Parts for other  
finishes can be found  
here: [Chrome](#)

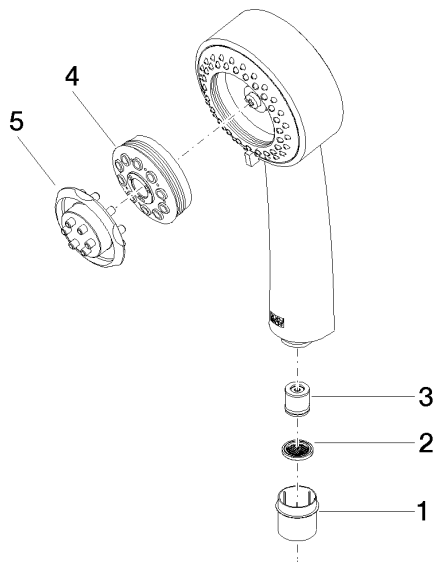

## Spare parts list

| No. | Item Number        | Name         | Quantity used | Delivery time |
|-----|--------------------|--------------|---------------|---------------|
| 2   | 09 23 01 039 90    | sieve        | 1.00          | 2             |
| 1   | 09 21 02 115 90    | cap          | 1.00          | 2             |
| 3   | 09 23 01 077 90    | flow reducer | 1.00          | 2             |
| 5   | 09 30 09 022 90    | key          | 1.00          | 2             |
| 4   | 04 12 11 071 00 90 | shower       | 1.00          | 2             |