

## Rain shower for surface-mounted ceiling installation with light 300 mm - Brushed Dark Platinum

TARA

28 032 970



Fits: TARA, LISSÉ, VAIA, META

- rain shower Ø 300 mm
- PURE RAIN, max. flow rate 12 l/min (at 3 bar)
- PURIFY RAIN, max. flow rate 6 l/min (at 3 bar)
- Distance to ceiling from bottom edge of shower 40 mm
- with anti-scale system
- central LED Spot 3000 K
- Provided by customer: Light switch
- For simultaneous control of the jet types, we recommend the xTool thermostat module
- Not suitable for use in a steam room.

**includes light bulbs with a Class F energy efficiency**

includes light bulbs with a Class F energy efficiency

|  |                                |               |
|--|--------------------------------|---------------|
|   | Brushed Dark Platinum          | 28 032 970-99 |
|   | Chrome                         | 28 032 970-00 |
|   | Brushed Platinum               | 28 032 970-06 |
|   | Platinum                       | 28 032 970-08 |
|   | Dark Chrome                    | 28 032 970-19 |
|   | Brushed Durabronze (23kt Gold) | 28 032 970-28 |
|   | Matte Black                    | 28 032 970-33 |
|   | Brushed Champagne (22kt Gold)  | 28 032 970-46 |
|   | Champagne (22kt Gold)          | 28 032 970-47 |
|  | Brushed Chrome                 | 28 032 970-93 |

### Required miscellaneous



#### **Concealed ceiling installation box for surface-mounted ceiling installation with light -**

35 042 970 90

- min. recess depth 90 mm
- max. recess depth 115 mm
- 2x female thread 1/2" connections
- Input 100-240V AC 50-60Hz
- concealed rough parts
- Output 350 mA SELV / Class II
- Provided by customer: Light switch

## Rain shower for surface-mounted ceiling installation with light 300 mm - Brushed Dark Platinum

TARA

28 032 970

mm [inches]



### Flow rate chart



### Certificates

LGA\_38400.

28 032 970

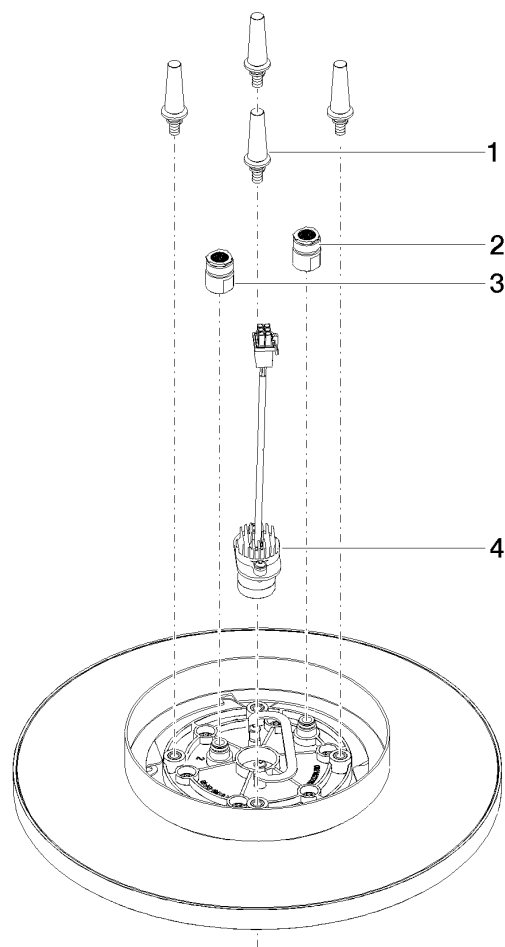

Spare parts list

| No. | Item Number        | Name                   | Quantity used | Delivery time |
|-----|--------------------|------------------------|---------------|---------------|
| 1   | 90 17 20 263 00 90 | fixing set             | 1             | 2             |
| 2   | 90 24 03 309 01 90 | connection             | 1             | 2             |
| 3   | 90 24 03 309 00 90 | connection             | 1             | 2             |
| 4   | 90 10 01 225 00 90 | electronic accessories | 1             | 2             |