

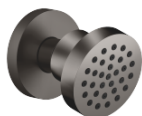





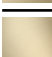

## Body spray without volume control FlowReduce - Brushed Dark Platinum

28 518 979 Product version from 4/1/2024



- spray head Ø 55mm
- ball-joint pivotable through 25° (in any direction)
- HORIZONTAL RAIN, max. flow rate 5 l/min (at 3 bar)
- with anti-scale system
- rosette Ø 55 mm
- 1/2" connection
- This product can help a building meet the requirements of Green Building Rating Systems, e.g. LEED®, BREEAM®, DGNB
- WRAS

|   |                               |               |
|---|-------------------------------|---------------|
|    | Brushed Dark Platinum         | 28 518 979-99 |
|    | Chrome                        | 28 518 979-00 |
|    | Brushed Platinum              | 28 518 979-06 |
|    | Platinum                      | 28 518 979-08 |
|    | Durabrass (23kt Gold)         | 28 518 979-09 |
|    | Dark Chrome                   | 28 518 979-19 |
|    | Light Gold                    | 28 518 979-26 |
|    | Brushed Light Gold            | 28 518 979-27 |
|   | Brushed Durabrass (23kt Gold) | 28 518 979-28 |
|  | Matte Black                   | 28 518 979-33 |
|  | Brushed Bronze                | 28 518 979-42 |
|  | Brushed Champagne (22kt Gold) | 28 518 979-46 |
|  | Champagne (22kt Gold)         | 28 518 979-47 |
|  | Brushed Chrome                | 28 518 979-93 |

### Recommended miscellaneous



- Concealed wall elbow -**
- max. recess depth mm
  - min. recess depth mm

35 085 970 90

**Body spray without volume control FlowReduce - Brushed Dark Platinum**

28 518 979 Product version from 4/1/2024

mm [inches]

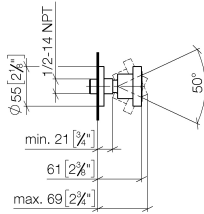

**Flow rate chart**



**Trajectory diagram**

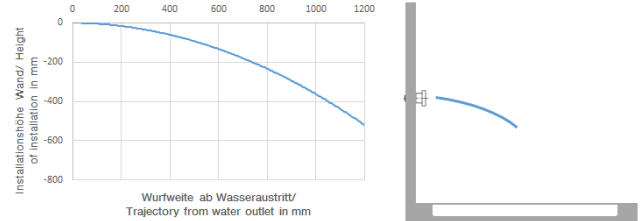

**Codes & Standards**

|                        |                             |           |          |
|------------------------|-----------------------------|-----------|----------|
| ASME A112.18.1         | cUPC                        | DIN 4109  | ISO 3822 |
| Scottish Water Byelaws | UK Water Supply Regulations | Ü-Zeichen |          |



Body spray without volume control FlowReduce - Brushed Dark Platinum

---

28 518 979 Product version from 4/1/2024

Certificates

---

|        |            |             |
|--------|------------|-------------|
| LGA_38 | IAPMO_4976 | WRAS_240602 |
|--------|------------|-------------|

# Body spray without volume control FlowReduce - Brushed Dark Platinum

28 518 979 Product version from 4/1/2024

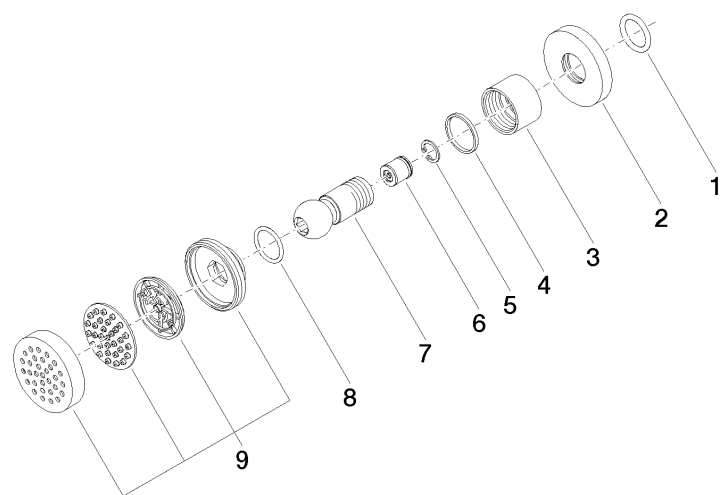

## Spare parts list

| No. | Item Number        | Name                  | Quantity used | Delivery time |
|-----|--------------------|-----------------------|---------------|---------------|
| 1   | 90 14 10 026 00 90 | seal                  | 1             | 2             |
| 2   | 09 27 22 019-99    | rosette               | 1             | 20            |
| 3   | 09 23 30 026-99    | nut                   | 1             | 20            |
| 4   | 09 14 15 010 90    | ring                  | 1             | 2             |
| 5   | 09 16 01 014 90    | ring                  | 1             | 2             |
| 6   | 09 23 01 048 90    | back-flow preventer   | 1             | 2             |
| 7   | 09 21 40 016-99    | connection            | 1             | 20            |
| 8   | 09 14 10 015 90    | seal                  | 1             | 2             |
| 9   | 90 12 05 027 00-99 | casing ( completely ) | 1             | 20            |