





CL.1 Wall valve clockwise closing cold 1/2" - Dark Chrome

CL.1

36 607 706

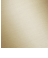

- rosette 60 x 60 mm
- with cold marking
- head part with cut-to-length spindle and sleeve
- WRAS 2010066

	Dark Chrome	36 607 706-19
	Chrome	36 607 706-00
	Brushed Platinum	36 607 706-06
	Brushed Champagne (22kt Gold)	36 607 706-46
	Champagne (22kt Gold)	36 607 706-47
	Brushed Dark Platinum	36 607 706-99

Required miscellaneous



- Wall valve 1/2" -**

35 607 970 90

 - max. recess depth 150 mm
 - min. recess depth 105 mm



CL.1 Wall valve clockwise closing cold 1/2" - Dark Chrome

CL.1

36 607 706

mm [inches]



Codes & Standards

DIN 4109	ISO 3822	Scottish Water Byelaws	UK Water Supply Regulations
----------	----------	---------------------------	--------------------------------

Ü-Zeichen

Certificates

WRAS_2010	LGA_29
-----------	--------

Product version from 10/14/2020

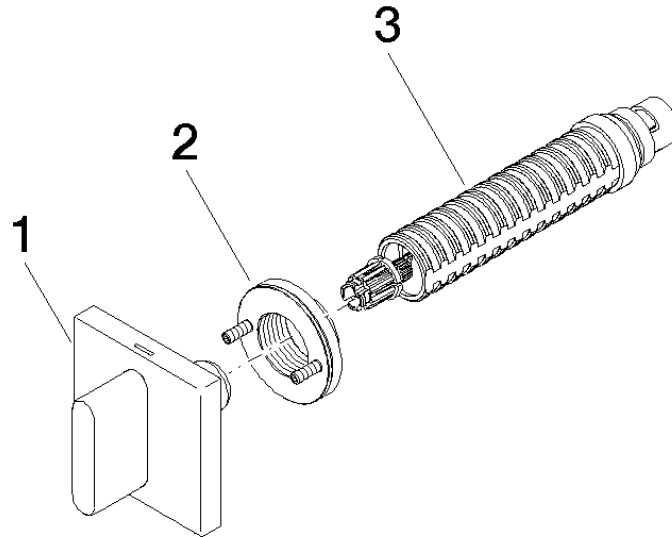



CL.1 Wall valve clockwise closing cold 1/2" - Dark Chrome

CL.1

36 607 706

Spare parts list

Product version from 10/14/2020

No.	Item Number	Name	Quantity used	Delivery time
	90 20 70 051 02-19	handle (cold)	3	20