

Rosette - Brushed Bronze

SERIES-VARIOUS

12 720 660
Product version from 7/1/2023



- rosette Ø 70 mm

Can only be combined with exposed trim parts 36 002 970-FF / 36 110 970-FF / 36 111 970-FF / 36 112 970-FF / 36 050 970-FF.

|   |                               |               |
|---|-------------------------------|---------------|
|    | Brushed Bronze                | 12 720 660-42 |
|    | Chrome                        | 12 720 660-00 |
|    | Brushed Platinum              | 12 720 660-06 |
|    | Platinum                      | 12 720 660-08 |
|    | Dark Chrome                   | 12 720 660-19 |
|    | Light Gold                    | 12 720 660-26 |
|    | Brushed Light Gold            | 12 720 660-27 |
|    | Brushed Durabrass (23kt Gold) | 12 720 660-28 |
|    | Matte Black                   | 12 720 660-33 |
|   | Brushed Champagne (22kt Gold) | 12 720 660-46 |
|  | Champagne (22kt Gold)         | 12 720 660-47 |
|  | Brushed Chrome                | 12 720 660-93 |
|  | Brushed Dark Platinum         | 12 720 660-99 |

12 720 660 Product version from 7/1/2023

mm [inches]



Parts for other  
finishes can be found  
here: [Chrome](#)

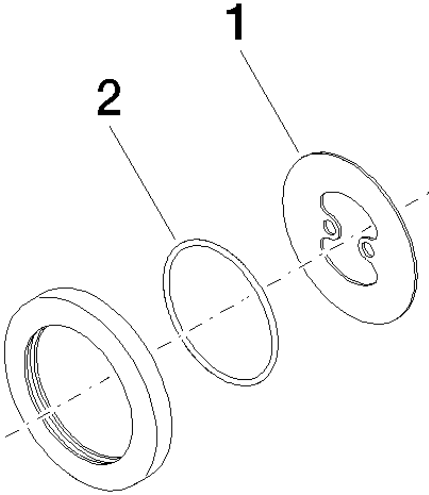

Spare parts list

| No. | Item Number     | Name | Quantity used | Delivery time |
|-----|-----------------|------|---------------|---------------|
| 1   | 09 30 11 291 90 | disc | 1.00          | 2             |
| 2   | 09 14 10 046 90 | seal | 1.00          | 2             |