

MADISON Showerpipe with shower mixer without hand shower FlowReduce - Brushed Platinum

MADISON







26 633 360



- shower with fixed riser projection 420mm
- overhead shower: rain flow
- rain shower Ø 200 mm
- max. rainshower flow 7 l/min
- rotary diverter for fixed-riser shower/hand shower
- height of fittings up to top edge of elbow 1180mm
- height of fittings up to rain shower (bottom edge) 1009mm
- rosette for shower holder Ø 66mm
- rosette for wall mounting Ø 70mm
- rosette for shower mixer Ø 60mm
- gauge 150 mm - 13 mm
- metal shower hose 1250mm with integrated anti-twist protection
- 1/2" connection
- Pipe diameter 20 mm
- This product can help a building meet the requirements of Green Building Rating Systems, e.g. LEED®, BREEAM®, DGNB

This article does not include a hand shower!

Intrinsic protection against back flow.

	Brushed Platinum	26 633 360-06
	Chrome	26 633 360-00
	Platinum	26 633 360-08
	Durabrand (23kt Gold)	26 633 360-09
	Brushed Durabrand (23kt Gold)	26 633 360-28
	Brushed Dark Platinum	26 633 360-99

MADISON Showerpipe with shower mixer without hand shower FlowReduce - Brushed Platinum

MADISON

26 633 360
mm [inches]



Flow rate chart



Codes & Standards

DIN 4109

EN 1717

ISO 3822

Ü-Zeichen



MADISON Showerpipe with shower mixer without hand shower FlowReduce - Brushed Platinum

MADISON

26 633 360

Certificates and sustainability

Belgaqua_24-004-2 LGA_38

MADISON Showerpipe with shower mixer without hand shower FlowReduce - Brushed Platinum

MADISON

26 633 360

Parts for other
finishes can be found
here: [Chrome](#)

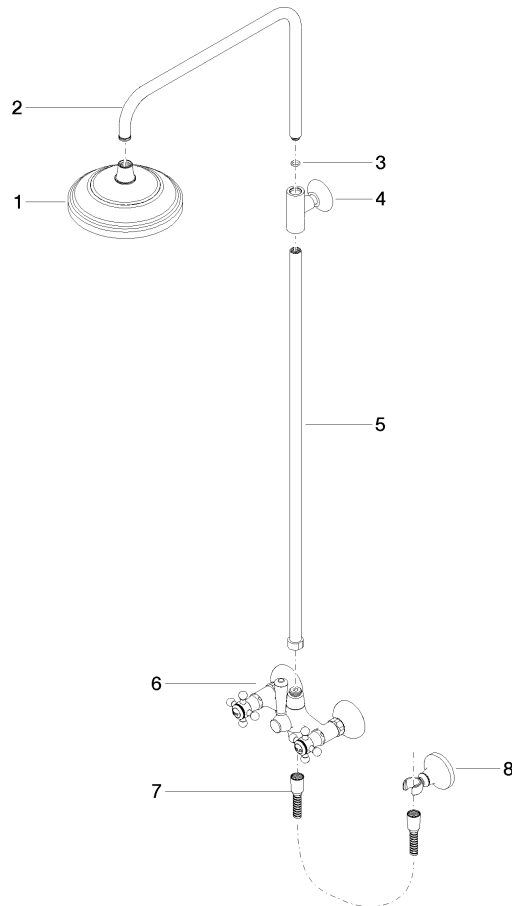

Spare parts list

No.	Item Number	Name	Quantity used	Delivery time
7	28 104 970-06	Metal shower hose 1/2" x 1/2" x 1250 mm - Brushed Platinum	1.00	2
6	04 17 10 001 00-06	fitting	1.00	60
5	90 28 22 096 00-06	pipe	1.00	10
1	90 12 05 038 20-06	shower	1.00	10
4	90 17 11 033 00-06	holder	1.00	-
Spare part can no longer be ordered, please order the replacement item				
3	90 14 10 011 00 90	seal	1.00	2
2	04 28 22 101 20-06	spout	1.00	10
8	28 050 410-06	holder	1.00	60