

MADISON Bath shower set for bath rim or tile edge installation - Brushed Dark Brass

MADISON







27 502 360

Product version from 7/31/2009



- spout: circular, air-enriched flow
- max. spout flow rate 23 l/min
- Hand shower: COMPACT RAIN, max. flow rate 6.8 l/min (at 3 bar)
- complete hand shower set with anti-scale system
- 225mm projection
- automatic bath/shower diverter
- height of mixer 185 mm
- height up to aerator 140 mm
- hole diameter valve 32 mm
- hole diameter spout 32 mm
- hole diameter for complete hand shower set 32 mm
- rosette for complete hand shower set Ø 55mm
- rosette for deck valve Ø 55mm
- metal shower hose 1750mm with integrated anti-twist protection

Intrinsic protection against back flow.

|   |                               |               |
|---|-------------------------------|---------------|
|  | Brushed Dark Brass            | 27 502 360-39 |
|  | Chrome                        | 27 502 360-00 |
|  | Brushed Platinum              | 27 502 360-06 |
|  | Platinum                      | 27 502 360-08 |
|  | Durabrass (23kt Gold)         | 27 502 360-09 |
|  | Brushed Durabrass (23kt Gold) | 27 502 360-28 |
|  | Brushed Dark Platinum         | 27 502 360-99 |

Recommended miscellaneous

|   |                                    |               |
|---|------------------------------------|---------------|
|  | <b>Perfecto installation kit -</b> | 12 614 970 90 |
|   | • 1 pair                           |               |

Recommended miscellaneous

|   |                                       |               |
|---|---------------------------------------|---------------|
|  | <b>Decorative caps for Perfecto -</b> | 12 801 970-39 |
|   | <b>Brushed Dark Brass</b>             |               |

# MADISON Bath shower set for bath rim or tile edge installation - Brushed Dark Brass

MADISON

27 502 360 Product version from 7/31/2009  
mm [inches]



## Flow rate chart



27 502 360 Product version from 7/31/2009

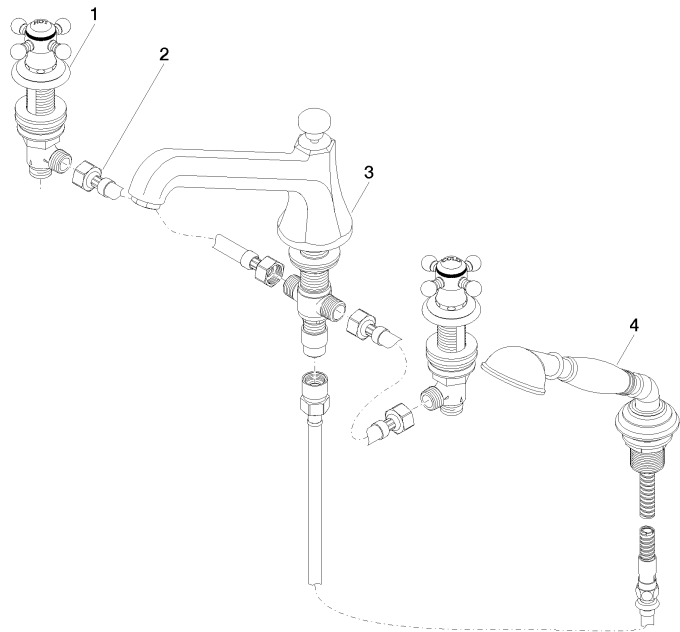

### Spare parts list

| No.  | Item Number   | Name                                      | Quantity used | Delivery time |
|--|---------------|---|---------------|---------------|
| 1  | 20 000 360-39 | side panel                                | 2.00          | -             |
| Spare part can no longer be ordered, please order the replacement item |               |   |               |               |
| 4  | 27 703 360-39 | shower set                                | 1.00          | -             |
| Spare part can no longer be ordered, please order the replacement item |               |   |               |               |
| 2  | 12 502 970 90 | High pressure hose 1/2" x 1/2" x 400 mm - | 2.00          | 2             |
| 3  | 13 502 380-39 | spout                                     | 1.00          | -             |
| Spare part can no longer be ordered, please order the replacement item |               |   |               |               |