

Shower head FlowReduce - Matte Black

SERIES SPECIFIC

28 508 980 Product version from 5/15/2020



- spray head Ø 92mm
- Three settings: COMPACT RAIN, COMPACT SOFT FLOW, COMPACT AQUAPRESSURE FLOW, max. flow rate 6.8 l/min (at 3 bar)
- Function from: l/min
- with anti-scale system

Technical data:

- 200mm projection
- ball-joint pivotable through 30°
- rosette 60 x 60 mm
- 1/2" connection

| | | |
|---|-------------------------------|--------------------|
|  | Matte Black | 28 508 980-33 0010 |
|  | Chrome | 28 508 980-00 0010 |
|  | Chrome | 28 508 980-00 |
|  | Brushed Platinum | 28 508 980-06 0010 |
|  | Brushed Platinum | 28 508 980-06 |
|  | Platinum | 28 508 980-08 0010 |
|  | Platinum | 28 508 980-08 |
|  | Dark Chrome | 28 508 980-19 0010 |
|  | Dark Chrome | 28 508 980-19 |
|  | Brushed Light Gold | 28 508 980-27 |
|  | Brushed Light Gold | 28 508 980-27 0010 |
|  | Brushed Durabrass (23kt Gold) | 28 508 980-28 0010 |
|  | Brushed Durabrass (23kt Gold) | 28 508 980-28 |
|  | Matte Black | 28 508 980-33 |
|  | Brushed Champagne (22kt Gold) | 28 508 980-46 0010 |
|  | Brushed Champagne (22kt Gold) | 28 508 980-46 |
|  | Champagne (22kt Gold) | 28 508 980-47 0010 |
|  | Champagne (22kt Gold) | 28 508 980-47 |
|  | Brushed Chrome | 28 508 980-93 0010 |
|  | Brushed Chrome | 28 508 980-93 |
|  | Brushed Dark Platinum | 28 508 980-99 0010 |
|  | Brushed Dark Platinum | 28 508 980-99 |



Codes & Standards

| | | | |
|----------------|------|----------|----------|
| ASME A112.18.1 | cUPC | DIN 4109 | ISO 3822 |
|----------------|------|----------|----------|

Ü-Zeichen

Certificates and sustainability

| | |
|--------|------------|
| LGA_38 | IAPMO_4976 |
|--------|------------|

28 508 980 Product version from 5/15/2020

Parts for other
 finishes can be found
 here: [Chrome](#)

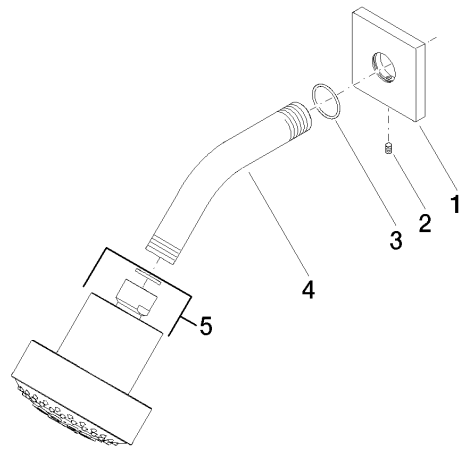

Spare parts list

| No. | Item Number | Name | Quantity used | Delivery time |
|-----|--------------------|------------|---------------|---------------|
| 2 | 09 31 11 048 90 | pin | 1.00 | 2 |
| 5 | 04 12 11 110 30-33 | shower | 1.00 | 30 |
| 4 | 09 11 03 011-33 | connection | 1.00 | 30 |
| 3 | 09 14 10 098 90 | seal | 1.00 | 2 |
| 1 | 09 27 98 003-33 | rosette | 1.00 | 30 |