

LISSÉ Single-lever bath mixer for wall mounting without shower set - Brushed Dark Platinum

LISSÉ







33 200 845

Product version from 4/1/2024



- 190-200mm projection
- circular normal flow
- automatic bath/shower diverter
- 3/8" shower outlet
- slide-on rosettes Ø 60 mm
- 1/2" connection
- gauge 150 mm - 15 mm
- max. flow 13.5 l/min at 3 bar flow pressure
- WRAS

Intrinsic protection against back flow.

| | | |
|---|-----------------------|---------------|
|  | Brushed Dark Platinum | 33 200 845-99 |
|  | Chrome | 33 200 845-00 |
|  | Brushed Platinum | 33 200 845-06 |
|  | Dark Chrome | 33 200 845-19 |
|  | Brushed Light Gold | 33 200 845-27 |
|  | Matte Black | 33 200 845-33 |
|  | Brushed Chrome | 33 200 845-93 |

LISSÉ Single-lever bath mixer for wall mounting without shower set - Brushed Dark Platinum

LISSÉ

33 200 845 Product version from 4/1/2024

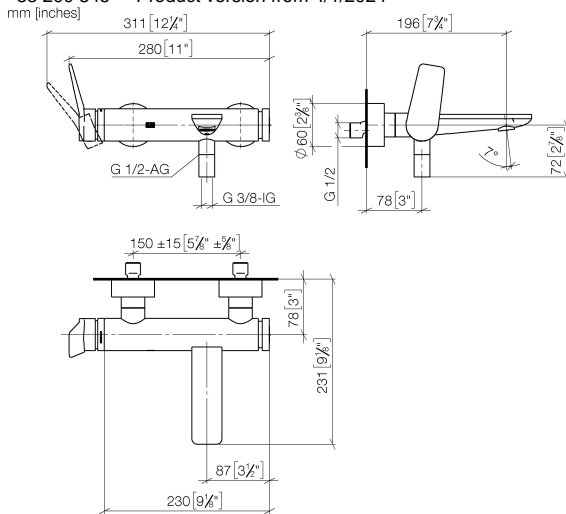

Flow rate chart



Codes & Standards

ASME A112.18.1 cUPC DIN 4109 ISO 3822

Scottish Water
Byelaws

UK Water Supply
Regulations

Ü-Zeichen



LISSE Single-lever bath mixer for wall mounting without shower set - Brushed
Dark Platinum

LISSE

33 200 845 Product version from 4/1/2024

Certificates and sustainability

LGA_9 WRAS_2311 IAPMO_4976 (

LISSÉ Single-lever bath mixer for wall mounting without shower set - Brushed Dark Platinum

LISSÉ

33 200 845 Product version from 4/1/2024

Parts for other
finishes can be found
here: [Chrome](#)

