

LOT Single-lever mixer - Chrome

LOT

33 800 680 Product version from 3/1/2023



- 236mm projection
- pivotable spout 360°
- air-enriched flow
- max. flow 8 l/min at 3 bar flow pressure
- lead-free
- This product can help a building meet the requirements of Green Building Rating Systems, e.g. LEED®, BREEAM®, DGNB

| | | |
|---|-------------------------------|---------------|
|  | Chrome | 33 800 680-00 |
|  | Brushed Platinum | 33 800 680-06 |
|  | Platinum | 33 800 680-08 |
|  | Dark Chrome | 33 800 680-19 |
|  | Brushed Durabrass (23kt Gold) | 33 800 680-28 |
|  | Brushed Bronze | 33 800 680-42 |
|  | Brushed Champagne (22kt Gold) | 33 800 680-46 |
|  | Champagne (22kt Gold) | 33 800 680-47 |
|  | Brushed Dark Platinum | 33 800 680-99 |

Recommended miscellaneous

Dispenser with rosette - Chrome 82 439 970-00



Recommended miscellaneous

Strainer waste with control handle - Chrome 10 711 970-00



LOT Single-lever mixer - Chrome

LOT

33 800 680 Product version from 3/1/2023



Flow rate chart



Codes & Standards

DIN 4109

ISO 3822

Ü-Zeichen



LOT Single-lever mixer - Chrome

LOT

33 800 680 Product version from 3/1/2023

Certificates and sustainability

LGA_38

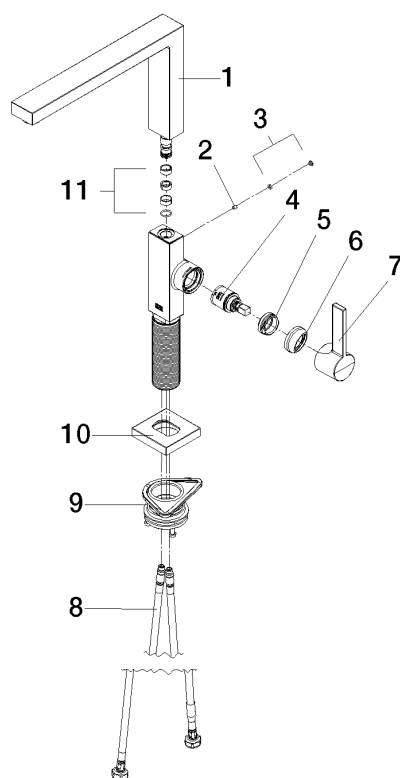

Spare parts list

| No. | Item Number | Name | Quantity used | Delivery time |
|-----|--------------------|------------|---------------|---------------|
| 1 | 90 11 06 218 00-00 | spout | 1.00 | 10 |
| 8 | 04 30 04 101 00 90 | hose | 2.00 | 2 |
| 9 | 90 30 10 057 00 90 | fixing set | 1.00 | 2 |
| 2 | 09 31 11 044 90 | pin | 1.00 | 2 |
| 3 | 90 31 20 087 00-00 | plug | 1.00 | 10 |
| 6 | 90 28 30 052 00-00 | cover | 1.00 | 10 |
| 11 | 90 28 10 207 00 90 | gasket kit | 1.00 | 2 |
| 5 | 09 24 04 266 90 | nut | 1.00 | 2 |
| 10 | 90 27 86 004 00-00 | rosette | 1.00 | 10 |
| 4 | 90 15 05 042 00 90 | cartridge | 1.00 | 2 |
| 7 | 90 20 86 004 00-00 | handle | 1.00 | 10 |