

MEM Concealed two-way diverter - Platinum

MEM

36 200 782 Product version from 4/1/2022



- rotary diverter
- rosette 60 x 60 mm
- WRAS

	Platinum	36 200 782-08
	Chrome	36 200 782-00
	Brushed Platinum	36 200 782-06
	Dark Chrome	36 200 782-19
	Brushed Durabrass (23kt Gold)	36 200 782-28
	Brushed Champagne (22kt Gold)	36 200 782-46
	Champagne (22kt Gold)	36 200 782-47
	Brushed Dark Platinum	36 200 782-99

Required miscellaneous

	Concealed two-way diverter -	35 202 970 90
	<ul style="list-style-type: none"> • max. recess depth 160 mm • min. recess depth 115 mm 	

mm [inches]



Flow rate chart



Codes & Standards

DIN 4109	ISO 3822	Scottish Water Byelaws	UK Water Supply Regulations
----------	----------	------------------------	-----------------------------

Ü-Zeichen



MEM Concealed two-way diverter - Platinum

MEM

36 200 782 Product version from 4/1/2022

Certificates and sustainability

LGA_38

WRAS_2307

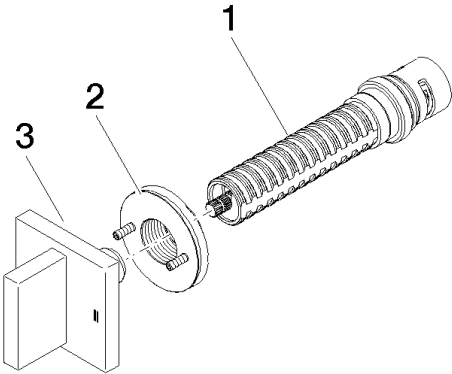

Spare parts list

No.	Item Number	Name	Quantity used	Delivery time
1	90 90 03 304 10 90	diverter	1.00	2
2	90 21 02 181 00 90	disc	1.00	2
3	90 20 78 002 08-08	handle	1.00	40