

MADISON Coude mural - Platine







MADISON

28 450 370 Version du produit jusqu'à 06/07/2018

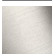

- sortie douche 1/2"
- rosace Ø 60 mm
- raccord 1/2"

Avec sécurité anti-retour.

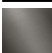
	Platine	28 450 370-08
	Chrome	28 450 370-00
	Chrome	28 450 370-00 0010
	Platine brossé	28 450 370-06
	Platine brossé	28 450 370-06 0010
	Platine	28 450 370-08 0010
	Laiton (Or 23cts)	28 450 370-09
	Laiton (Or 23cts)	28 450 370-09 0010
	Laiton brossé (Or 23cts)	28 450 370-28
	Laiton brossé (Or 23cts)	28 450 370-28 0010
	Dark Brass brossé	28 450 370-39
	Dark Platinum brossé	28 450 370-99
	Dark Platinum brossé	28 450 370-99 0010

Accessoires recommandés



- Coude mural à encastrer - 35 085 970 90**
- profondeur de montage max. 163 mm
 - profondeur de montage mini. 90 mm



Diagramme de débit



Codes & Standards

EN 1717

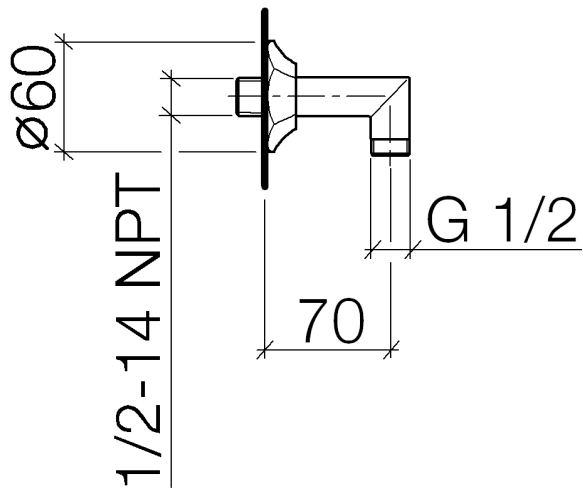
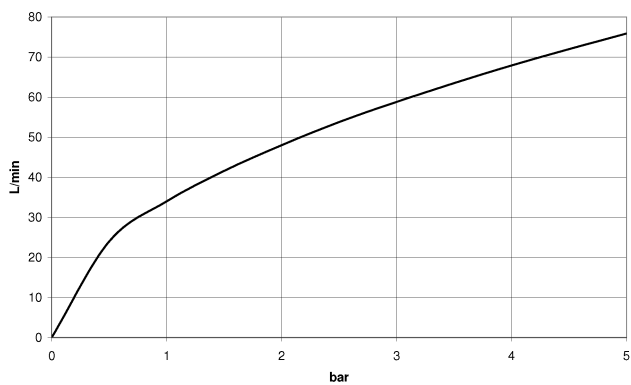
Scottish Water
Byelaws

UK Water Supply
Regulations



MADISON Coude mural - Platine

MADISON

28 450 370 Version du produit jusqu'à 06/07/2018

Certificats et durabilité

Belgaqua_21-381-2 WRAS_240502

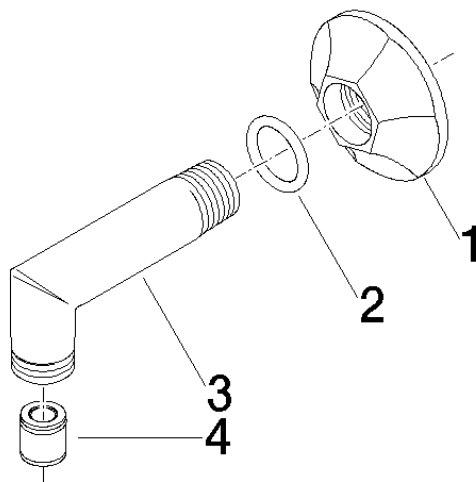

Liste des pièces de rechange

N°	Article Numéro	Désignation	Fréquence de montage	Délai de livraison
3	09 11 03 021-08	raccord	1,00	40
1	09 27 37 003-08	rosace	1,00	40
4	90 23 01 040 00 90	anti-retour	1,00	2
2	90 14 10 026 00 90	joint	1,00	2