

MADISON Douche de tête FlowReduce - Platine brossé

MADISON











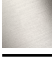

28 508 360 Version du produit de 01/07/2025



- pomme de douche Ø 94 mm
- 3 jets réglables : COMPACT RAIN, COMPACT SOFT FLOW, COMPACT AQUAPRESSURE FLOW, débit max. 7,6 l/min (à 3 bar)
- Fonction à partir de: l/min
- avec système anti-calcaire

Données techniques :

- saillie 200 mm
- rotule 30° pivotante
- rosace Ø 55 mm
- raccord 1/2"

	Platine brossé	28 508 360-06 0010
	Chrome	28 508 360-00 0010
	Chrome	28 508 360-00
	Platine brossé	28 508 360-06
	Platine	28 508 360-08 0010
	Platine	28 508 360-08
	Laiton (Or 23cts)	28 508 360-09 0010
	Laiton (Or 23cts)	28 508 360-09
	Laiton brossé (Or 23cts)	28 508 360-28 0010
	Laiton brossé (Or 23cts)	28 508 360-28
	Dark Brass brossé	28 508 360-39 0010
	Dark Brass brossé	28 508 360-39
	Dark Platinum brossé	28 508 360-99 0010
	Dark Platinum brossé	28 508 360-99

mm [inches]

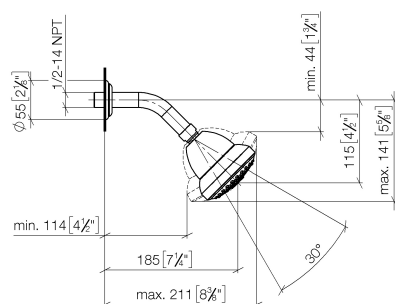

Codes & Standards

DIN 4109

ISO 3822

Ü-Zeichen

Certificats et durabilité

LGA_38

Les pièces pour les
autres finitions
peuvent être
trouvées ici : Chrome

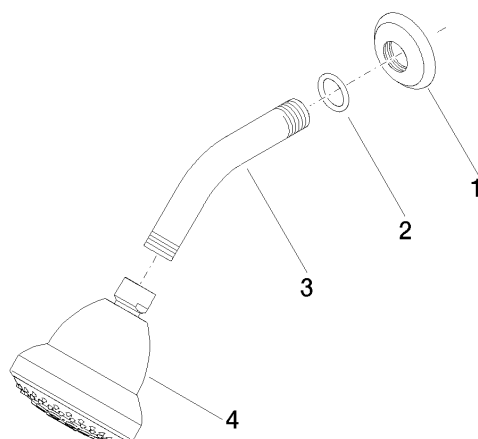

Liste des pièces de rechange

N°	Article Numéro	Désignation	Fréquence de montage	Délai de livraison
4	04 12 11 120 01-06	douche	1,00	10
3	09 11 03 011-06	raccord	1,00	10
1	09 27 35 003-06	rosace	1,00	10
2	90 14 10 026 00 90	joint	1,00	2